

INDEX OF SHEETS	
SHEET DESCRIPTION	SHEET NO(S)
TITLE	1
INDEX OF SHEETS AND ADDENDA AND REVISIONS	2
LEGEND	3
NOTES	4
CONSTRUCTION PLANS (CP)	5
BRIDGE PLAN AND ELEVATION	6-7
REPAIR DETAILS	8
ENVIRONMENTAL COMPLIANCE NOTES (EC)	9
ENVIRONMENTAL COMPLIANCE PLANS (EC)	10
CONSTRUCTION PHASING, M.O.T. AND EROSION CONTROL NOTES	11
CONSTRUCTION PHASING, M.O.T. AND EROSION CONTROL PLANS	12
DETOUR PLANS	13
SIGNING, STRIPING AND CONDUIT PLANS (SS)	14
RIGHT-OF-WAY PLAN	15
RIGHT-OF-WAY DATA SHEET	16

16-DEC-2024
 17:23
 \\csM-del00p0w21\CS_paf_work_dir\135079634_11\1501_BRSE_T202407601_DOT.dgn

ADDENDA / REVISIONS		SCALE AS NOTED	PAVEMENT & REHABILITATION, SUSSEX I, (HARDSCRABBLE & CONCORD), 2025	CONTRACT	BRIDGE NO.	3-243	INDEX OF SHEETS AND ADDENDA AND REVISIONS	SECTION
				T202506301	DESIGNED BY:	M. HADDAD		SHEET NO.
				COUNTY	CHECKED BY:	S. RODRIGUEZ		02
				SUSSEX				

MANMADE ROADSIDE FEATURES			
FEATURE DESCRIPTION	EXISTING	PROPOSED	ID
BARRIER - DOUBLE-FACED, PERMANENT			
BARRIER - SINGLE-FACED, PERMANENT, TEST LEVEL 4 / TEST LEVEL 5	BARRIER, TYPE "X"		B XXX
BARRIER - HIGH TENSION CABLE (HTCB)			
BARRIER - HTCB END TERMINAL			
BOLLARD - STEEL POLE			
BOLLARD - WOOD POST			
CURB, TYPE 1 AND TYPE 3			
CURB, TYPE 2	CURB, TYPE "X"		
CURB & GUTTER, TYPE 1			C XXX
CURB & GUTTER, TYPE 2			
CURB & GUTTER, TYPE 3	C&G, TYPE "X"		
CURB OPENING - SUMP / ON GRADE			C O
CURB/SW OPENING - ADJACENT CURB			CO SW
CURB/SW OPENING - NON-ADJACENT CURB			
FENCE - CHAINLINK OR STRANDED			F XXX
FENCE - STOCKADE OR SPLIT RAIL			
FLAG POLE	F.P.		
GUARDRAIL - STEEL BEAM, TYPE 1			
GUARDRAIL - STEEL BEAM, TYPE 2			
GUARDRAIL - STEEL BEAM, TYPE 3			
GUARDRAIL - WIRE ROPE			
GUARDRAIL - END ANCHORAGE			OR XXX
GUARDRAIL - END TREATMENT, TYPE 1			
GUARDRAIL - END TREATMENT, TYPE 2			
GUARDRAIL - END TREATMENT, TYPE 3			
IMPACT ATTENUATOR			
LAMP AND POST - RESIDENTIAL	LAMP		
MAILBOX	MB		
PARKING METER AND POST	P.M.		
PAVEMENT - FLEXIBLE			
PAVEMENT - RIGID			
PILE - BRIDGE			
PILLAR OR MISCELLANEOUS POST			
TRAFFIC SIGN AND POST			
WALL - BRICK OR BLOCK			
WALL - STONE			

DRAINAGE FEATURES			
FEATURE DESCRIPTION	EXISTING	PROPOSED	ID
BIOFILTRATION SWALE			
DITCH OR STREAM (V-SHAPE / TRAPEZOIDAL)			
DIRECTIONAL STREAM FLOW ARROW			
DRAINAGE INLET	C.B. / D.I.		DI XXX
DRAINAGE JUNCTION BOX	J.B.		JB XXX
DRAINAGE MANHOLE			RM XXX
DRAINAGE PIPE AND FLOW ARROW	SIZE/TYPE LABEL		P XXX
FLARED END SECTION			FE2 XXX
RIPRAP - AREA FEATURE			RR XXX
RIPRAP - LINEAR FEATURE			
SAFETY END STRUCTURE			SES XXX
UNDERDRAIN			UD XXX
UNDERDRAIN OUTLET			UDO XXX

UTILITY FEATURES			
FEATURE DESCRIPTION	EXISTING	PROPOSED	
COMMUNICATIONS DISTRIBUTION BOX			
COMMUNICATIONS MANHOLE			
COMMUNICATIONS TEST POINT			
COMMUNICATIONS - UNDERGROUND	COMM(A)	COMM	
ELECTRIC - UNDERGROUND	E(A)	E	
ELECTRIC MANHOLE			
ELECTRIC METER			
ELECTRIC TRANSFORMER			
GAS - UNDERGROUND	G(A)	G	
GAS MANHOLE			
GAS METER	G.M.		
GAS VALVE	G.V.		
GAS PUMP - SERVICE STATION	G.P.		
IRRIGATION - UNDERGROUND	IR(A)	IR	
ITMS - UNDERGROUND	ITMS(A)	ITMS	
LIGHTING - UNDERGROUND	LI(A)	LI	
LUMINAIRE - POLE MOUNTED			
MANHOLE - UNDETERMINED OWNER			
RAILROAD TRACKS			
SANITARY - UNDERGROUND	S(A)	S	
SANITARY SEWER MANHOLE			
SANITARY SEWER VALVE	S.V.		
SANITARY SEWER CLEANOUT OR VENT	S.C.O.		
SEPTIC DRAIN FIELD	S.D.F.		
SIGNALIZATION - UNDERGROUND	SIG(A)	SIG	
SOIL BORING LOCATION			
TELEPHONE BOOTH			
TRAFFIC - CONDUIT JUNCTION WELL	J.W.		
TRAFFIC - LIGHT POLE AND BASE			
TRAFFIC - PEDESTRIAN POLE & BASE			
TRAFFIC - SIGNAL CABINET & BASE			
TRAFFIC - SIGNAL POLE AND BASE			
UTILITY BOX			
UTILITY MARKER			
UTILITY POLE GUY WIRE ANCHOR			
UTILITY POLE			
UTILITY TEST HOLE LOCATION			
WATER - UNDERGROUND	W(A)	W	
WATER - FIRE HYDRANT	F.H.	F.H.	
WATER METER	W.M.		
WATER VALVE	W.V.	W.V.	
WELL HEAD	WELL		

PAVEMENT SECTION(S)	
MILL AND OVERLAY - 2" BITUMINOUS CONCRETE MILLING (760010) OR PCC MILLING (760013) 2" TYPE C PG 76-22, NC STONE (401046)	
N/A	
N/A	

NATURAL ROADSIDE FEATURES		
FEATURE DESCRIPTION	EXISTING	PROPOSED
HEDGEROW OR THICKET		
MARSH BOUNDARY LINE		
TREE - CONIFEROUS		
TREE - DECIDUOUS		
TREE STUMP		
SHRUBBERY		
WETLAND BOUNDARY - DELINEATED	WL	
WOODS LINE BOUNDARY		

RIGHT-OF-WAY FEATURES		
FEATURE DESCRIPTION	EXISTING	PROPOSED
DENIAL OF ACCESS	DA	DA
EASEMENT - OTHERS	EASEMENT TYPE	
PERMANENT EASEMENT	PE	PE
PROPERTY LINE		
PROPERTY MARKER - CONCRETE	C.M.	
PROPERTY MARKER - IRON PIPE	I.P.	
RIGHT-OF-WAY BASELINE	100+00	100+00
RIGHT-OF-WAY LINE	R/W	R/W
RIGHT-OF-WAY BY PE	R/W-PE	
RIGHT-OF-WAY & DENIAL OF ACCESS	R/W-DA	R/W-DA
RIGHT-TO-ENTER		RTE
TEMPORARY CONSTRUCTION EASEMENT		TCE
CONTRACTOR RIGHT TO TRESPASS		CRT

SURVEY CONTROL & MONUMENTATION	
FEATURE DESCRIPTION	EXISTING
POINT OF CURVATURE OR TANGENCY	
POINT OF INTERSECTING TANGENTS	
SURVEY BENCHMARK LOCATION	B.M.
SURVEY NGS POINT LOCATION	
SURVEY TIE POINT LOCATION	T.P.
SURVEY TRAVERSE POINT	

MISCELLANEOUS FEATURES	
FEATURE DESCRIPTION	PROPOSED
BRICK PATTERNED SURFACE	
BUTT JOINT	
CLEAR ZONE	CZ
CONSTRUCTION BASELINE	100+00
LATERAL OFFSET	LO
LIMIT OF CONSTRUCTION	LOC
PAVEMENT PATCH	
PAVEMENT REMOVAL - TOPSOIL, SEED AND MULCH	
P.C.C. SIDEWALK - 4"	
P.C.C. SIDEWALK - 6" (USE 8" DEPTH FOR CHANNELIZATION ISLANDS.)	

IDENTIFIERS	
FEATURE DESCRIPTION	ID
ABANDON BY CONTRACTOR	AB C
ABANDON BY OTHERS	AB O
ADJUST BY CONTRACTOR	A C
ADJUST BY OTHERS	A O
BEST MANAGEMENT PRACTICE	BMP XXX
BUS STOP PAD / TYPE	BSP X
BUS STOP WITH SHELTER PAD / TYPE	BSP X
CONCRETE SAFETY BARRIER	B XXX
CONVERT TO JUNCTION BOX	CB XXX
CONVERT TO DRAINAGE MANHOLE	CMH XXX
DO NOT DISTURB	DND
ENERGY DISSIPATOR	ED XXX
FILL WITH FLOWABLE FILL	FF C
LANDSCAPE PLANTINGS	LS XXX
PEDESTRIAN CONNECTION / TYPE	PC X
PEDESTRIAN CONNECTION / TYPE WITHOUT DETECTABLE WARNING SYSTEM	PC-N XXX
RELOCATE BY CONTRACTOR	RL C
RELOCATE BY OTHERS	RL O
RELOCATE BY PROPERTY OWNER	RL PO
REMOVE BY CONTRACTOR	RM C
REMOVE BY OTHERS	RM O
REMOVE BY TRAFFIC CONTRACTOR	RM TC
RIGHT-OF-WAY MONUMENT	M XXX

LAST REVISED: 03/13/2024
16/DEC/2024
17/12
\\scm-del00p0w21\CS_pdf_work_dir\134919634_5\LG01_BRSF_T202407601_DOT.dgn

ADDENDA / REVISIONS

NOT TO SCALE

PAVEMENT & REHABILITATION, SUSSEX I, (HARDSCRABBLE & CONCORD), 2025

CONTRACT	BRIDGE NO.	3-243
T202506301	DESIGNED BY:	M. HADDAD
COUNTY	CHECKED BY:	S. RODRIGUEZ
SUSSEX		

LEGEND

SECTION	BR
SHEET NO.	03

GENERAL NOTES

1. THIS PROJECT IS TO BE CONSTRUCTED IN ACCORDANCE WITH THE DELAWARE DEPARTMENT OF TRANSPORTATION "STANDARD SPECIFICATIONS", DATED JANUARY 2025 AND THE DELAWARE DEPARTMENT OF TRANSPORTATION "STANDARD CONSTRUCTION DETAILS", DATED 2025.

2. ELECTRONIC DESIGN DATA FILES THAT WILL BE MADE AVAILABLE TO THE BIDDERS INCLUDE:

()	NONE
()	ASCII DATA FILES WITH COORDINATES AND ELEVATIONS FOR PROPOSED POINTS AS SELECTED BY THE ENGINEER.
(X)	DESIGN FILE, IN .DGN FILE FORMAT, THAT CONTAINS 3D TRIANGLES REPRESENTING THE EXISTING SURFACE.
()	DESIGN FILE, IN .DGN FILE FORMAT, THAT CONTAINS 3D FEATURE LINES FOR THE PROPOSED DESIGN. 3D FEATURE LINES ARE FOR THE PROPOSED TOP SURFACE ELEVATION ONLY.

NOTE: THE DOCUMENT ENTITLED "ELECTRONIC FILE SHARING RELEASE" MUST BE SIGNED BY ALL PARTIES PRIOR TO THE DELIVERY OF ANY ELECTRONIC PROJECT FILES.

NOTE: THERE MAY BE SOME AREAS OF THE PROJECT NOT INCLUDED IN THE ELECTRONIC DESIGN DATA FILE(S). IT IS THE CONTRACTOR'S RESPONSIBILITY TO REVIEW THE DESIGN DATA FILE AND DETERMINE THE LIMITS OF THE PROJECT INCLUDED.

3. PROJECT FILES THAT WILL BE MADE AVAILABLE TO THE CONTRACTOR, INCLUDE:

()	CROSS SECTIONS
(X)	RIGHT-OF-WAY PLANS (INCLUDED IN THE ADVERTISED PLANSET)

PROJECT NOTES

SECTION 100

- ANY DAMAGE TO ITEMS NOTED TO BE RELOCATED OR RESET BY THE CONTRACTOR, AT THE DISCRETION OF THE ENGINEER, SHALL BE REPAIRED AND/OR REPLACED IN KIND AT THE CONTRACTOR'S EXPENSE.
- THE CONTRACTOR WILL CONTACT THE DELAWARE TMC AT 302-659-4600 PRIOR TO ANY UNMANNED AERIAL VEHICLE (UAV) FLIGHTS. THE CONTRACTOR WILL BE REQUIRED TO PROVIDE THE FOLLOWING INFORMATION: THE REGISTRATION NUMBER OF THE UAV, THE FLIGHT TIME, LOCATION OF THE FLIGHT, THE PILOT'S NAME AND THE PILOT'S CONTACT NUMBER DURING THE FLIGHT.
- NIGHT WORK IS NOT PERMITTED ON THIS PROJECT UNLESS THE CONTRACTOR OBTAINS: APPROVAL FROM THE ENGINEER, ACCEPTABLE RESPONSES ON NIGHT WORK SURVEYS, AND ACCEPTANCE FROM THE MUNICIPALITY. METHOD AND FORMAT OF NIGHT WORK SURVEYS WILL BE PROVIDED BY THE ENGINEER UPON REQUEST. NIGHT WORK, SURVEYS, AND COORDINATION WITH MUNICIPALITIES IS NOT COMPENSABLE AND THE TIME TO COMPLETE THE SURVEYS IS NOT EXCUSABLE.

SECTION 200

- ONLY EXISTING FEATURES WITHIN THE LOC IDENTIFIED WITH REMOVE BY CONTRACTOR OR BY OTHER METHODS ARE TO BE REMOVED OR DISTURBED.
- FILLING VOIDS UNDER THE FOOTERS IS PAID UNDER ITEM 208000 - FLOWABLE FILL

SECTION 700

- ALL PAVED AREAS TO BE RECONSTRUCTED OR WIDENED SHALL BE SAWCUT AT THE POINT WHERE THE NEW PAVEMENT IS TO TIE INTO THE EXISTING PAVEMENT.

MISCELLANEOUS

7. THE CONTRACTOR SHALL NOTIFY DART FIRST STATE AT DOT_DETOURS@DELAWARE.GOV AT LEAST 14 DAYS PRIOR TO THE START OF ANY DETOURS OR CONSTRUCTION, AND DOT_DTC_PROJECTDEVELOPMENT@DELAWARE.GOV AT SUCH TIME THE FACILITY IS COMPLETED AND OPERABLE FOR TRANSIT OPERATIONS. FOR EMERGENCY DETOUR INFORMATION ONLY, PLEASE CONTACT DTC'S CHIEF SCHEDULER AT 302-576-6019.

8. DESIGN SPECIFICATIONS:
 (A) DELDOT BRIDGE DESIGN MANUAL, 2024 EDITION
 (B) AASHTO LRFD BRIDGE SPECIFICATIONS, 2020, 9TH EDITION, CUSTOMARY U.S. UNITS.

9. HYDRAULIC DATA:
 DRAINAGE AREA: 3.85 SQ. MILES DESIGN FREQ.: 50 YEARS
 DESIGN DISCHARGE: 504.8 CFS 100-YEAR DISCHARGE: 634.1 CFS
 EXISTING (DESIGN STORM) WSE: 7.00 FT PROPOSED (DESIGN STORM) WSE: 7.00 FT
 EXISTING (DESIGN STORM) VELOCITY: 9.71 FPS PROPOSED (DESIGN STORM) VELOCITY: 9.71 FPS
 EXISTING 100-YEAR WSE: 7.00 FT PROPOSED 100-YEAR WSE: 8.00 FT
 EXISTING 100-YEAR VELOCITY: 10.86 FPS PROPOSED 100-YEAR VELOCITY: 10.86 FPS
 EXISTING WATERWAY OPENING: 112 SQ. FT PROPOSED WATERWAY OPENING: 112 SQ. FT

10. SCOUR ANALYSIS:
 SCOUR DESIGN FREQUENCY: 200 YEARS OR OVERTOPPING (AS PER GUIDANCE OF SECTION 104.4 - 'SCOUR EVALUATION AND PROTECTION' AND FIGURE 104-8)
 SCOUR DESIGN FLOOD DISCHARGE: 786.20 CFS
 SCOUR DESIGN FLOOD VELOCITY: 12.09 FPS (AT BRIDGE OUTLET)
 WATER SURFACE ELEVATION: 8.03 FT (IMMEDIATELY UPSTREAM OF BRIDGE)
 CALCULATED SCOUR DEPTH AT EACH SUBSTRUCTURE UNIT: 2.2 FT UNDER FOOTERS

SCOUR COUNTERMEASURES HAVE BEEN DESIGNED FOR THE SCOUR DESIGN FLOOD IN ACCORDANCE WITH HEC 23 - BRIDGE SCOUR AND STREAM INSTABILITY COUNTERMEASURES AND/OR HEC 14 - HYDRAULIC DESIGN OF ENERGY DISSIPATORS FOR CULVERTS AND CHANNELS

11. ANY STAGING AND/OR STOCKPILE AREA(S) OUTSIDE THE PROJECT'S LIMIT OF CONSTRUCTION (LOC) THAT INDIVIDUALLY OR CUMULATIVELY ARE LARGER THAN 10,000 SQUARE FEET, MUST BE APPROVED BY DELDOT'S ARCHAEOLOGIST. CONTACT THE CONSTRUCTION AREA ENGINEER WHO WILL COORDINATE WITH DELDOT'S ARCHAEOLOGIST.

WITHIN 30 DAYS, DELDOT WILL:

- APPROVE THE USE OF THE PROPOSED STAGING AND STOCKPILE AREA(S);
- REJECT THE REQUEST; OR
- PERFORM AN ARCHAEOLOGICAL SURVEY TO DETERMINE WHETHER TO APPROVE OR REJECT THE REQUEST, WHICH MAY TAKE UP TO 3 MONTHS. IF AN ARCHAEOLOGICAL SURVEY IS NECESSARY, DELDOT OR A CONSULTANT ON ITS BEHALF WILL UNDERTAKE THE SURVEY.

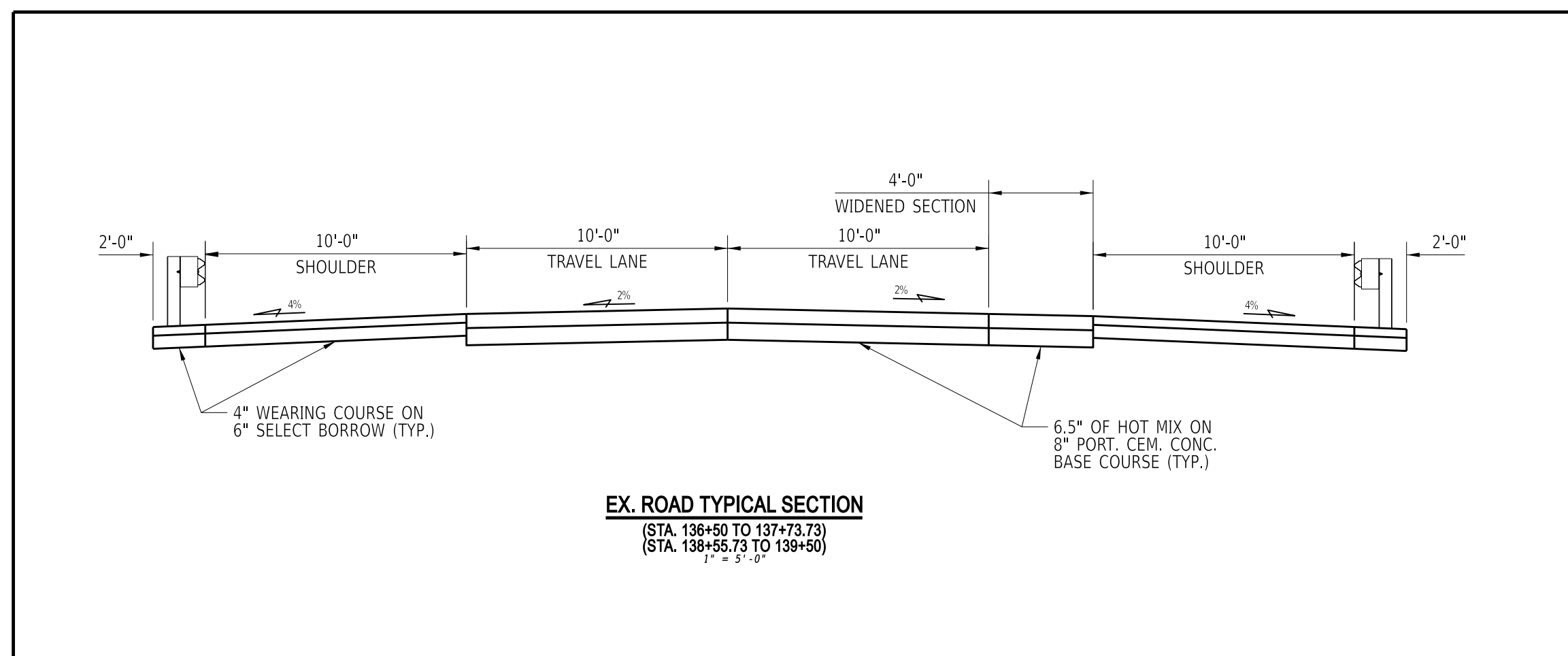

ADDENDA / REVISIONS

NOT TO SCALE

**PAVEMENT & REHABILITATION,
 SUSSEX I, (HARDSCRABBLE &
 CONCORD), 2025**

CONTRACT	BRIDGE NO.	3-243
T202506301	DESIGNED BY:	M. HADDAD
COUNTY	CHECKED BY:	S. RODRIGUEZ
SUSSEX		

NOTES

SECTION
BR
SHEET NO.
04

CONSTRUCTION ALIGNMENT CONTROL				
POINT NO.	STATION	OFFSET	NORTHING	EASTING
10000	136+50.00	0.000	233463.7857	613984.2018
10001	139+50.00	0.000	233471.6709	614284.0981

HORIZONTAL / VERTICAL CONTROL DATA					
POINT NO.	STATION	OFFSET	NORTHING	EASTING	ELEV.
TP-100	136+18.69	129.4093	233337.4424	613956.1997	2.2150
TP-101	136+65.07	104.6836	233359.5344	614002.0159	2.2150
TP-102	137+36.04	117.8185	233348.2694	614073.3067	2.2150
TP-103	138+19.53	89.3101	233378.9624	614156.0205	3.3240
TP-200	139+38.68	-74.6749	233546.0224	614270.8165	15.2680
TP-201	138+41.89	-131.2405	233600.0244	614172.5714	4.4130
TP-202	137+69.69	-133.5610	233600.4464	614100.3373	2.5730
TP-4	136+51.87	-23.4465	233487.2734	613985.4595	8.3110
TP-5	137+98.45	-15.7043	233483.3864	614132.1860	9.9890
TP-6	141+41.67	-193.0638	233499.8899	614475.0885	20.2230
TP-7	138+08.94	20.3200	233447.6504	614143.6244	10.0490
TP-8	136+47.61	27.7983	233436.0374	613982.5359	7.7500

- NOTES:
- PROPERTY LINE LOCATIONS ARE APPROXIMATE AND EXISTING RIGHT OF WAY INFORMATION IS SHOWN FOR INFORMATIONAL PURPOSES ONLY PER CONTRACT 64-01-024.
 - SOIL AND PAVEMENT STRUCTURE STABILIZATION AND LIFTING (ITEM #610511)
 - MILL ASPHALT AND CONCRETE SLAB (ITEM #760010 AND #760013) BEFORE LIFTING
 - FIELD VERIFY THE THICKNESS OF THE SLAB. FIELD VERIFYING THE THICKNESS OF THE SLAB SHALL BE PAID UNDER ITEM #763501 - CONSTRUCTION ENGINEERING.
 - PERFORM SOIL AND PAVEMENT STRUCTURE STABILIZATION AND LIFTING UNTIL SLAB TIES INTO EXISTING ROADWAY AND HAS POSITIVE DRAINAGE. FIELD VERIFYING SLOPE OF ROADWAY FOR POSITIVE DRAINAGE SHALL BE PAID UNDER ITEM #763501 - CONSTRUCTION ENGINEERING.
 - AFTER LIFTING THE SLAB, BUT BEFORE HOT MIXING, PERFORM CRACK AND JOINT SEALING LESS THAN 3/4-INCH WIDE (ITEM #504001) AND PATCH ANY HOLES IN THE SLAB USING PCC PATCHING, PARTIAL DEPTH (ITEM #505000).

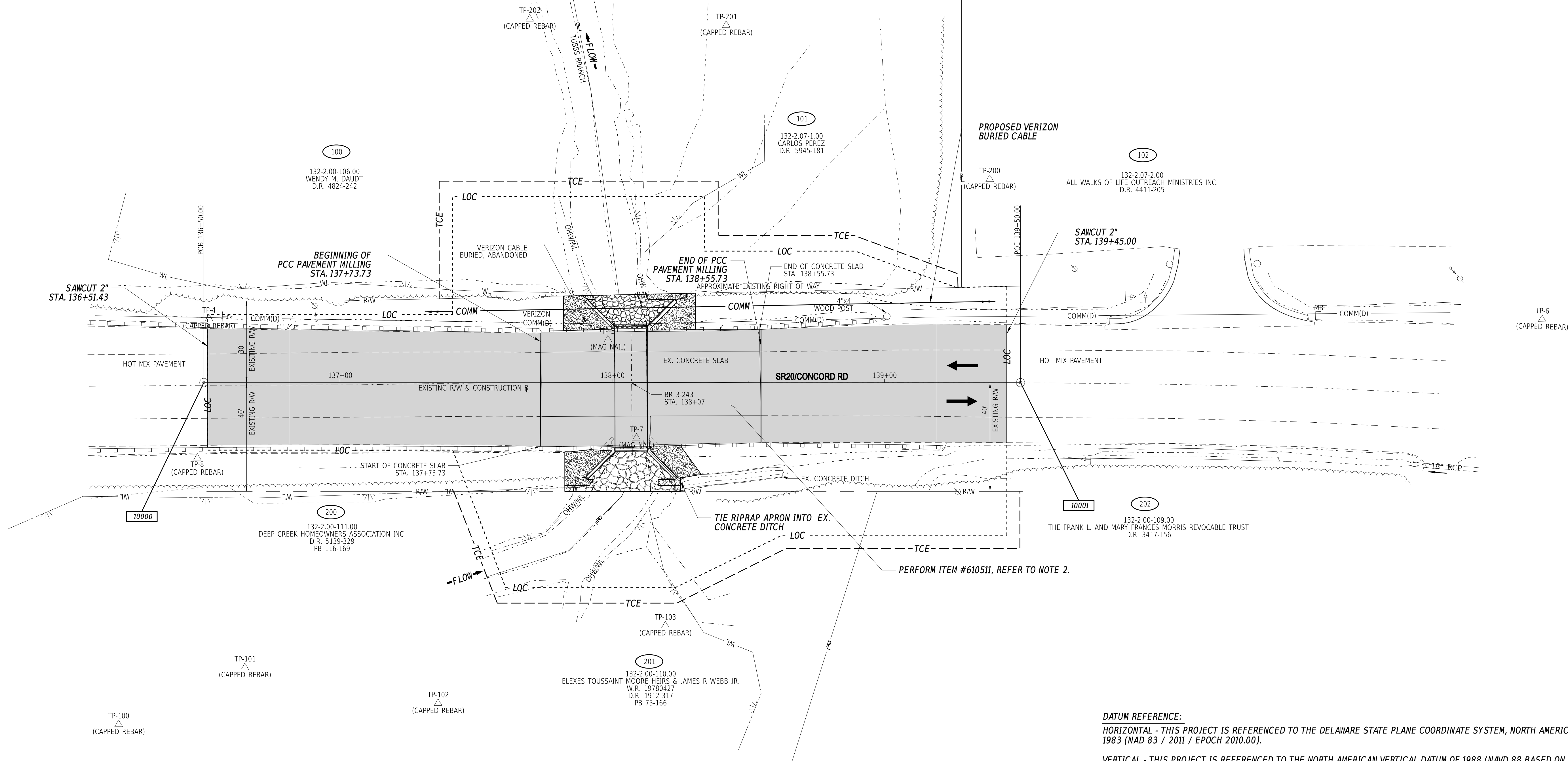

DATUM REFERENCE:
 HORIZONTAL - THIS PROJECT IS REFERENCED TO THE DELAWARE STATE PLANE COORDINATE SYSTEM, NORTH AMERICAN DATUM OF 1983 (NAD 83 / 2011 / EPOCH 2010.00).
 VERTICAL - THIS PROJECT IS REFERENCED TO THE NORTH AMERICAN VERTICAL DATUM OF 1988 (NAVD 88 BASED ON MODELED GEOID 12A).

24-JUL-2025 21:03 \\srm-del001\p21\CS_pof_work_dir\498819634_7\CP01_BRSF_T202407601_DOT.dgn

ADDENDA / REVISIONS	

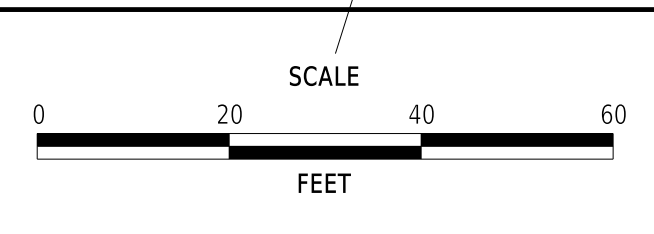

PAVEMENT & REHABILITATION, SUSSEX I, (HARDSCRABBLE & CONCORD), 2025

CONTRACT	BRIDGE NO.	3-243
T202506301	DESIGNED BY:	M. HADDAD
COUNTY	CHECKED BY:	S. RODRIGUEZ
SUSSEX		

CONSTRUCTION PLAN	SECTION	BR
	SHEET NO.	05

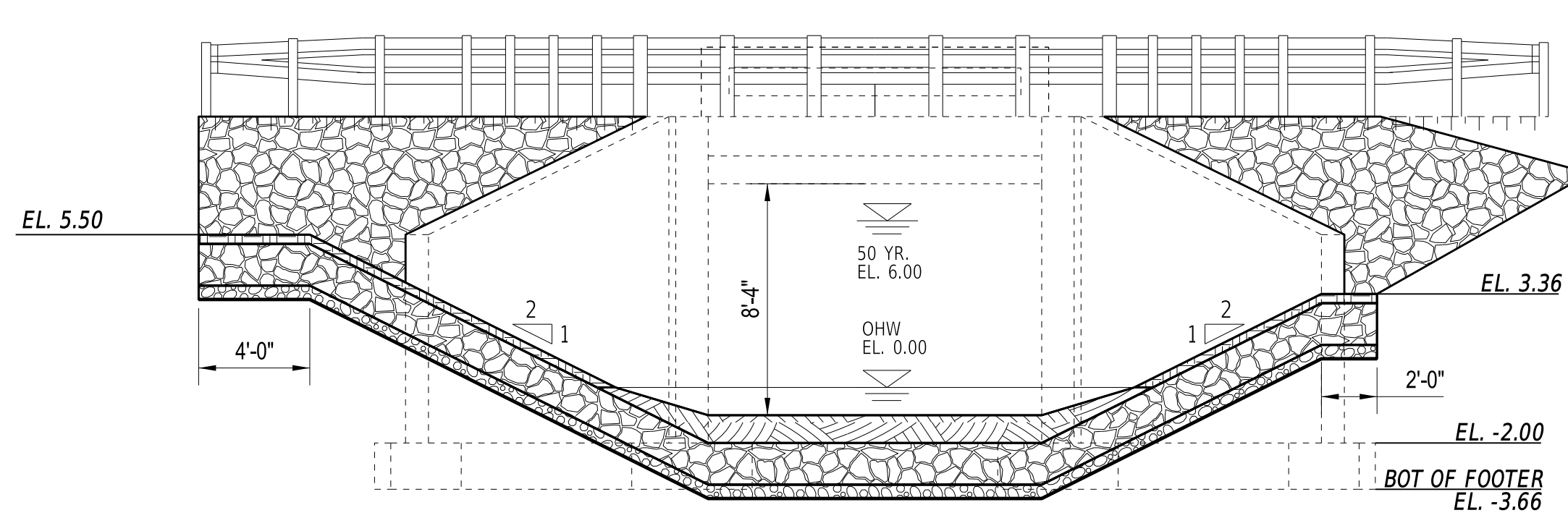

UPSTREAM ELEVATION
(SECTION D-D)
1" = 5'-0"

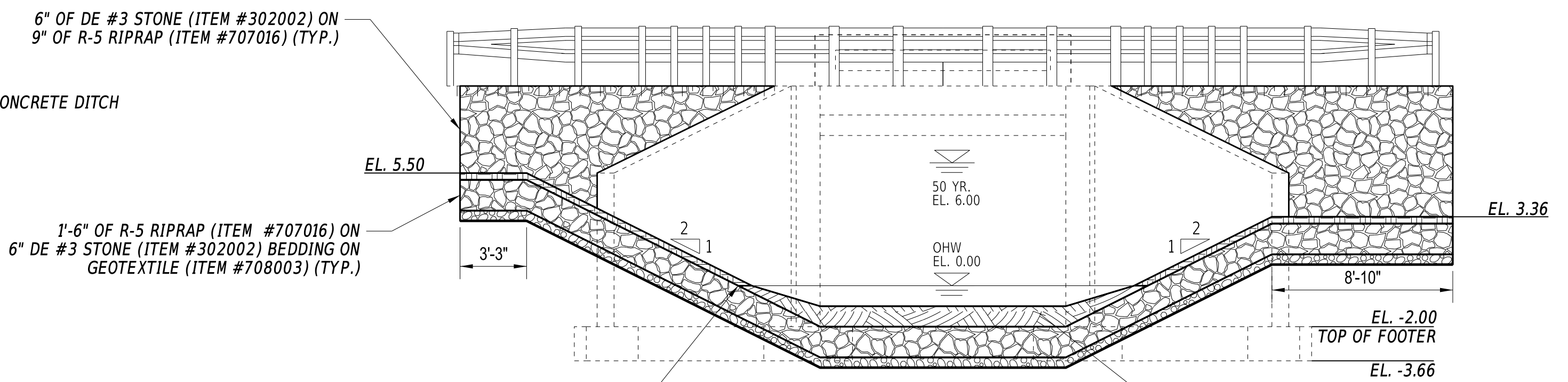

DOWNSTREAM ELEVATION
(SECTION C-C)
1" = 5'-0"

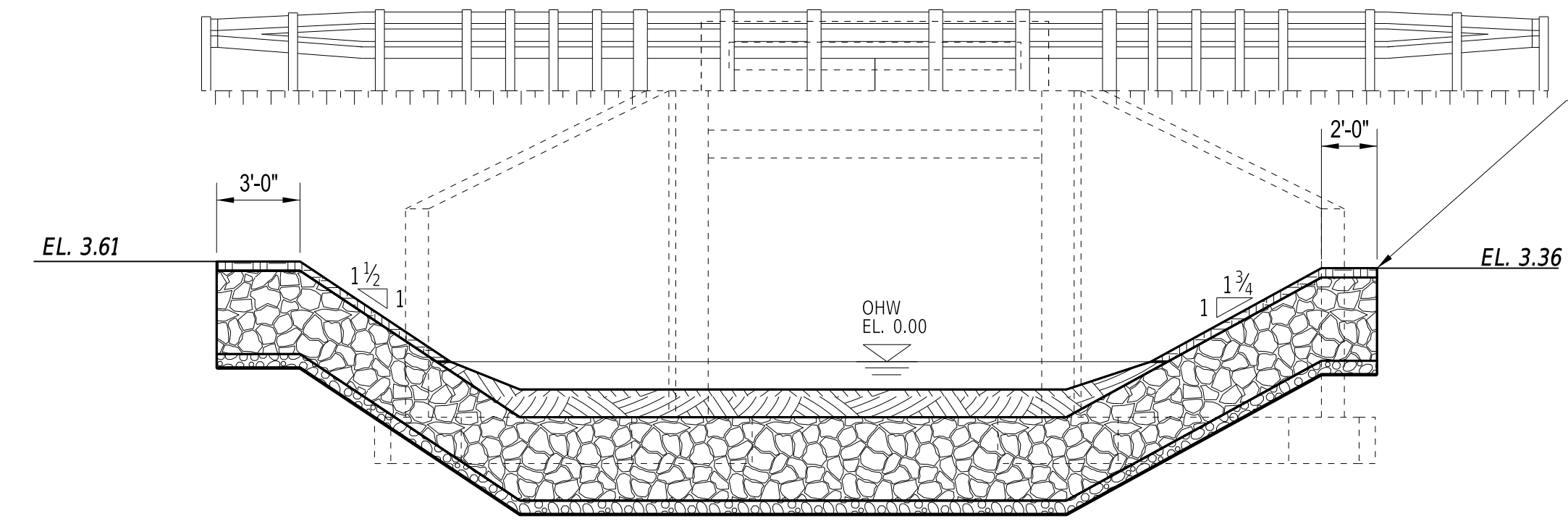

UPSTREAM RIPRAP TOEWALL
(SECTION D-D)
1" = 5'-0"

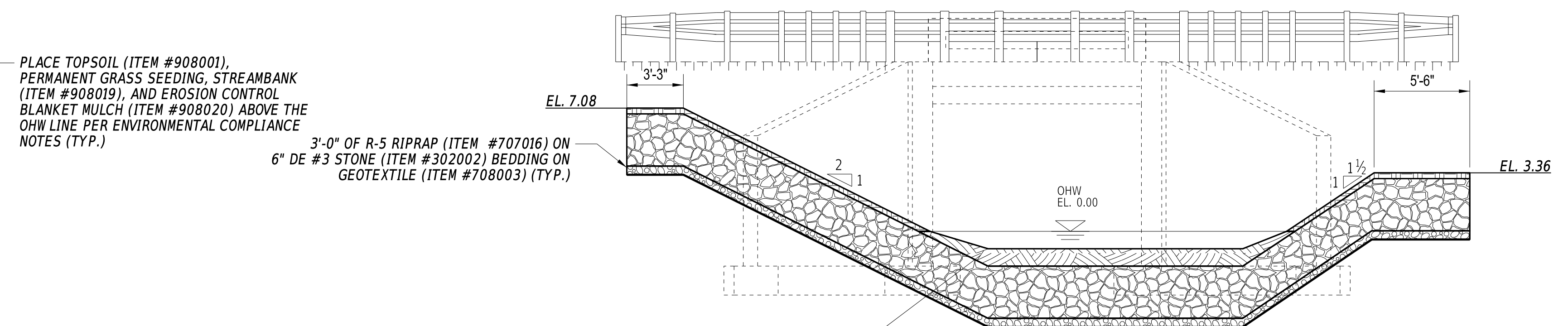

DOWNSTREAM RIPRAP TOEWALL
(SECTION C-C)
1" = 5'-0"

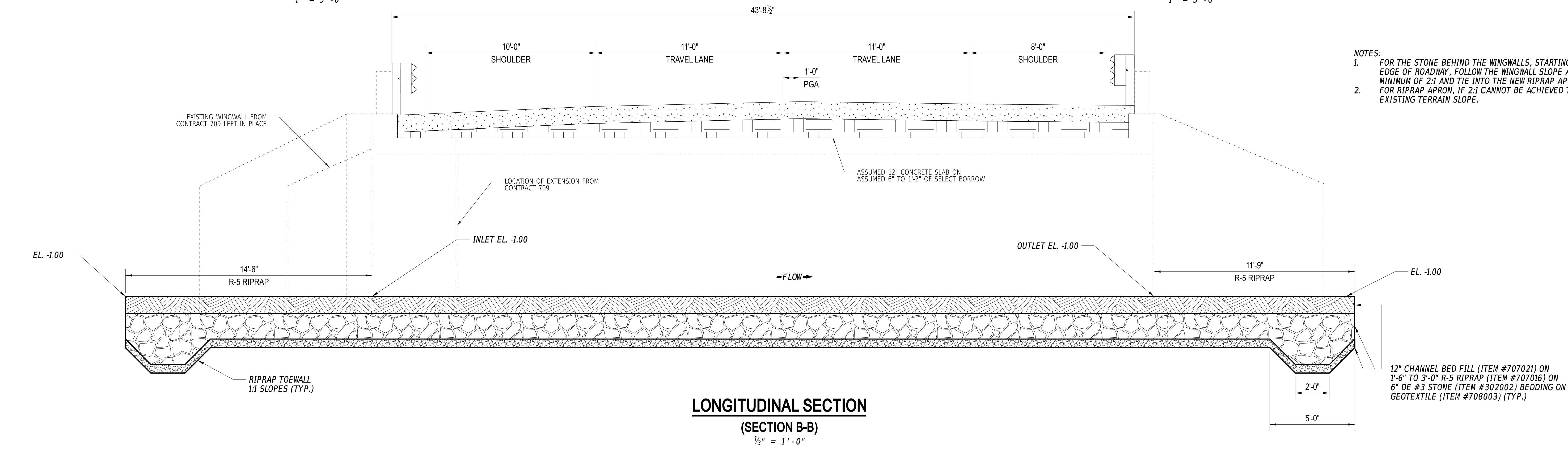

LONGITUDINAL SECTION
(SECTION B-B)
1/2" = 1'-0"

- NOTES:**
- FOR THE STONE BEHIND THE WINGWALLS, STARTING FROM THE EDGE OF ROADWAY, FOLLOW THE WINGWALL SLOPE AT A MINIMUM OF 2:1 AND TIE INTO THE NEW RIPRAP APRON.
 - FOR RIPRAP APRON, IF 2:1 CANNOT BE ACHIEVED THEN MATCH EXISTING TERRAIN SLOPE.

24-JUL-2025 21:03 \\scm-delldp02\1\CS_pdf_work_dir\498919634_2\PE02_BRSF_T202407601_DOT.dgn

ADDENDUM DIMENSIONS		SCALE AS NOTED	PAVEMENT & REHABILITATION, SUSSEX I, (HARDSCRABBLE & CONCORD), 2025	CONTRACT	BRIDGE NO.	3-243	ELEVATION AND LONGITUDINAL SECTION	SECTION
				T202506301	DESIGNED BY:	M. HADDAD		SHEET NO.
		COUNTY	SUSSEX	CHECKED BY:	S. RODRIGUEZ	07		

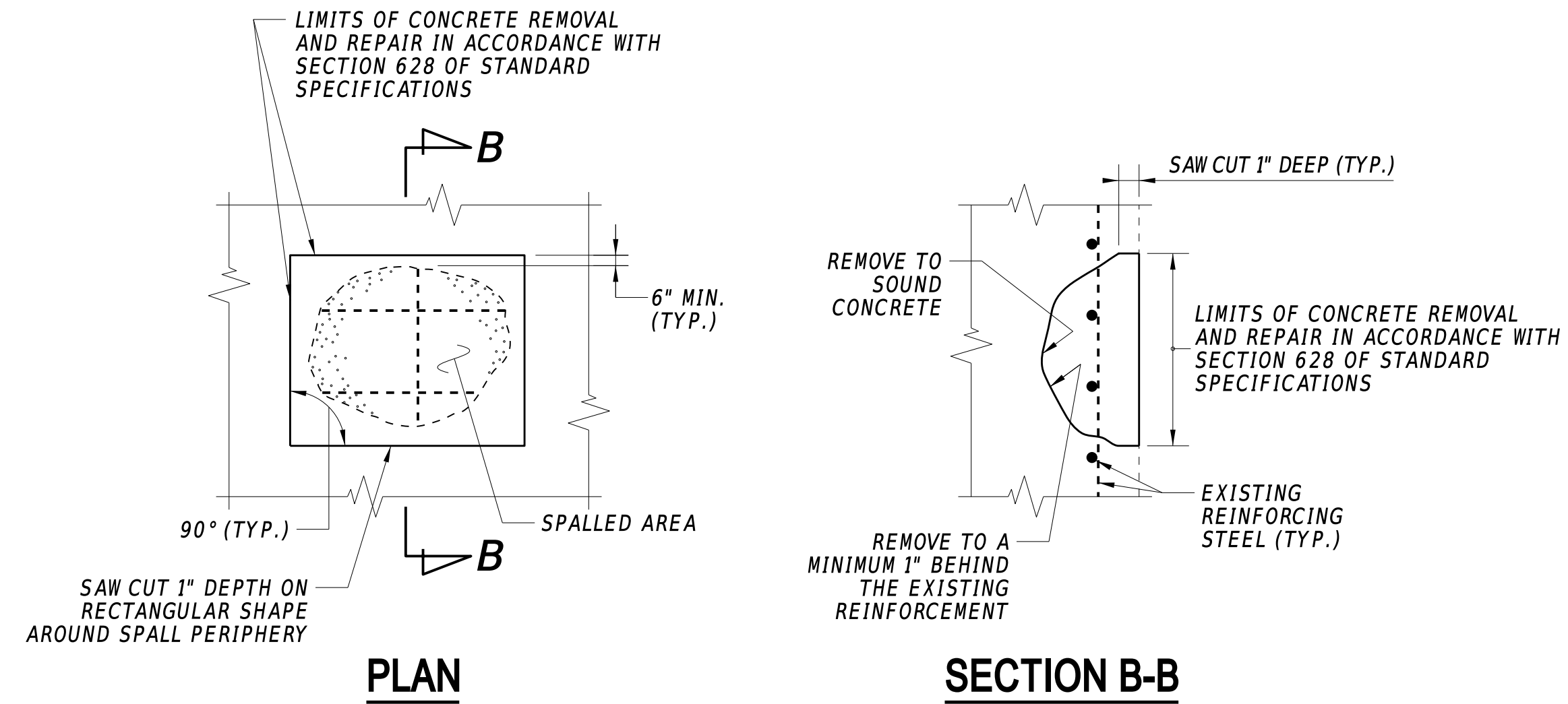

DEEP SPALL REPAIR

DEEP SPALL REPAIR NOTES

1. DEEP SPALLS ARE DEFINED AS PATCHES THAT EXTEND BELOW THE TOP MAT OF REINFORCEMENT.
2. ALL WORK INVOLVING METHODS OF CONCRETE REMOVAL, CLEANING OF CONCRETE SURFACE AND EXISTING REINFORCEMENT, REPAIRING OR REPLACING DAMAGED REINFORCEMENT AS RESULT OF CONSTRUCTION ACTIVITIES OR SECTION LOSS, PRESENCE OF CONTRACTION OR EXPANSION JOINTS, SURFACE PREPARATION, AND CONCRETE PLACEMENT SHALL BE PERFORMED IN ACCORDANCE WITH SECTION 628.3.4 OF THE STANDARD SPECIFICATIONS. PAYMENT INCIDENTAL TO 628041 - DEEP SPALL REPAIR.
3. SEE SPECIAL PROVISION DEEP OVERHEAD CONCRETE SPALL REPAIR - ITEM #628508 FOR OVERHEAD SPALL REPAIRS.

DECK CRACK NOTES

1. APPROX. LENGTH: 42 FT.
2. APPROX. LENGTH: 36 FT.
3. APPROX. LENGTH: 42 FT.
4. APPROX. LENGTH: 24 FT.
5. APPROX. LENGTH: 42 FT.
6. APPROX. LENGTH: 24 FT.

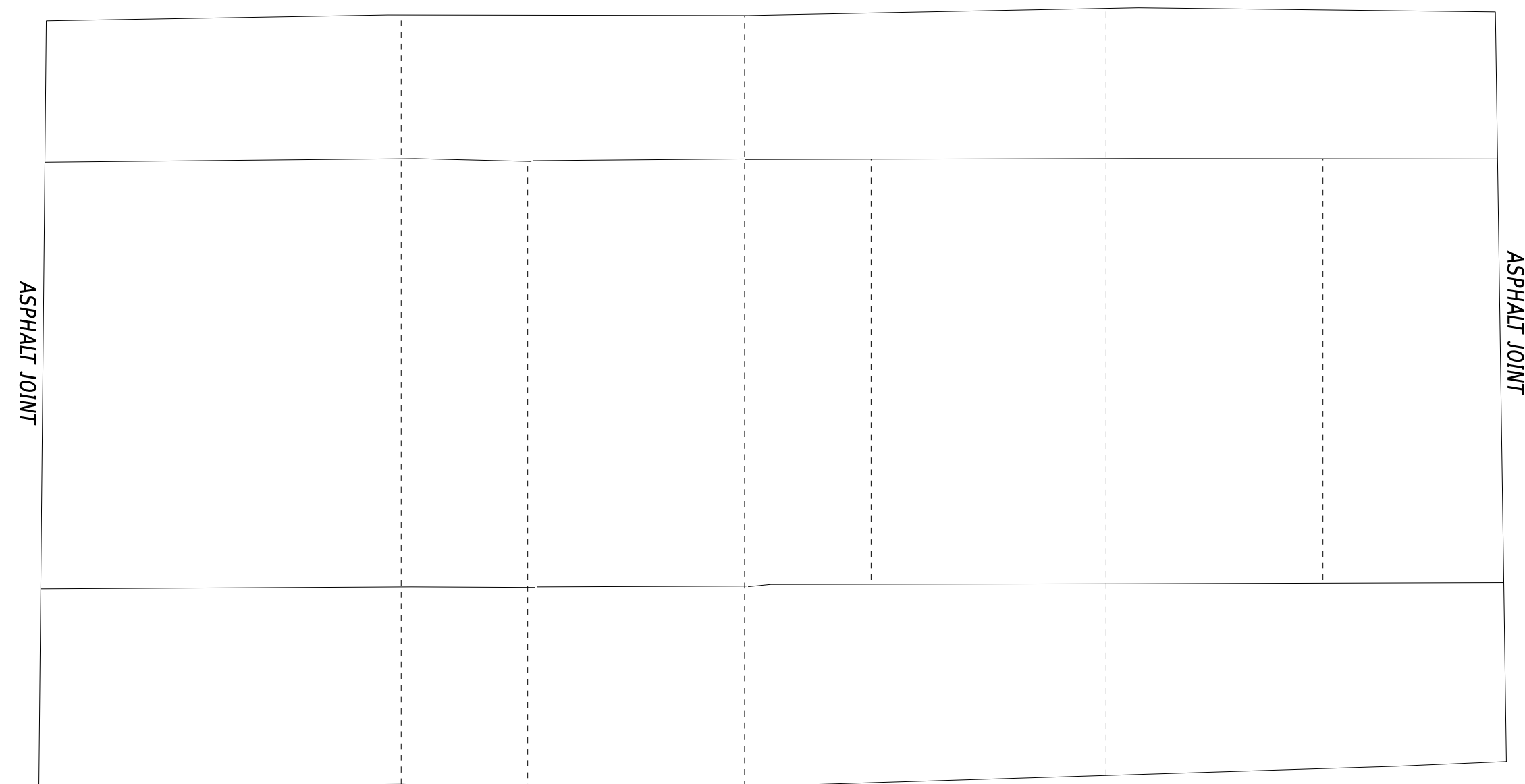
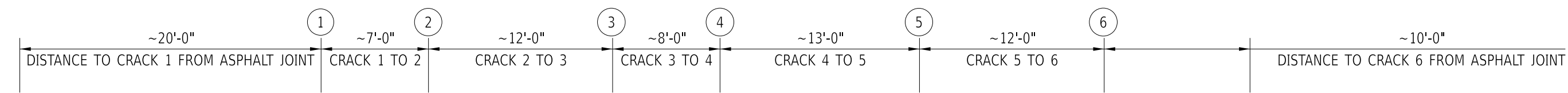

APPROX. DECK CRACK LOCATIONS

ADDENDA / REVISIONS

NOT TO SCALE

**PAVEMENT & REHABILITATION,
SUSSEX I, (HARDSCRABBLE &
CONCORD), 2025**

CONTRACT	BRIDGE NO.	3-243
T202506301	DESIGNED BY:	M. HADDAD
COUNTY	CHECKED BY:	S. RODRIGUEZ
SUSSEX		

REPAIR DETAILS

SECTION
BR
SHEET NO.
08

ENVIRONMENTAL COMPLIANCE NOTES

1. GENERAL NOTES:

- A. THE PURPOSE OF THIS SHEET IS TO IDENTIFY THOSE ITEMS ASSOCIATED WITH ENVIRONMENTAL COMPLIANCE. IMPACT CALCULATIONS ARE FOR THE AGENCY PERMIT REPORTING PURPOSES ONLY AND ARE NOT TO BE USED FOR BIDDING PURPOSES.
- B. IF A DEPARTURE FROM THE APPROVED PLANS (WHICH WOULD AFFECT ANY NATURAL AND/OR CULTURAL RESOURCES) IS NECESSARY, CONTACT THE ENVIRONMENTAL STUDIES SECTION AT (302-760-2264 OR DOT_ENVIRONMENTALSTUDIES@DELAWARE.GOV) TO ALLOW FOR COORDINATION WITH THE APPROPRIATE RESOURCE AGENCIES AND APPROVAL.
- C. USE OF THIS SHEET DOES NOT ALLEVIATE THE CONTRACTOR'S RESPONSIBILITY TO COMPLY WITH ALL CONDITIONS SET FORTH IN THE ENVIRONMENTAL STATEMENT AND PERMITS.

2. NATURAL RESOURCE ISSUES:

- A. PERMIT REQUIREMENTS/APPROVALS *:
 - U.S. ARMY CORPS OF ENGINEERS (COE): NATIONWIDE PERMIT #3 (A) AND (C) NO PCN REQUIRED.
 - DNREC - WETLANDS & SUBAQUEOUS LANDS (WLSL): SPECIAL EXEMPTION B
 - DNREC - WATER QUALITY (WQC) & COASTAL ZONE CONSISTENCY (CZM): ISSUED
- * THE PERMITS/APPROVALS LISTED ARE THOSE REQUIRED FOR THIS PROJECT. THE ENVIRONMENTAL STUDIES SECTION IS RESPONSIBLE FOR COORDINATING AND/OR OBTAINING THESE APPROVALS.
- ** THE CONTRACTOR MUST ENSURE THAT THESE PERMITS/APPROVALS ARE IN THEIR POSSESSION PRIOR TO BEGINNING CONSTRUCTION IN THE PERMITTED AREA(S) AND ENSURE THEY ARE DISPLAYED ON-SITE DURING THE ENTIRE CONSTRUCTION PERIOD.
- B. CONSTRUCTION RESTRICTIONS:
 - FISHERIES - NO IN-WATER WORK FROM MARCH 15TH - JUNE 30TH
 - TREE CLEARING - MAY 15TH - JULY 31ST
 - RARE PLANTS - IMPLEMENT STRINGENT SEDIMENT CONTROL MEASURES TO MINIMIZE IMPACTS.
 - STATE NATURAL AREA - AVOID NATIVE VEGETATION REMOVAL AND STAGE EQUIPMENT TO REDUCE IMPACTS TO THE NANTICOKE RIVER NATURAL AREA.
 - ENDANGERED SPECIES - IF MUSSELS ARE FOUND AT THE PROJECT SITE, PLEASE CONTACT DELDOT ENVIRONMENTAL STUDIES STAFF DOT_ENVIRONMENTALSTUDIES@DELAWARE.GOV. MUSSELS SHOULD BE RELOCATED TO AN ADJACENT SITE OUT OF THE AREA OF SEDIMENTATION.
 - MIGRATORY BIRDS - IF BRIDGE WORK IS PROPOSED DURING THE BREEDING SEASON (APRIL 15 TO AUGUST 1), CONTACT DELDOT ENVIRONMENTAL STUDIES VIA EMAIL AT DOT_ENVIRONMENTALSTUDIES@DELAWARE.GOV NO MORE THAN 14 DAYS PRIOR TO THE START OF WORK FOR A SURVEY TO DETERMINE IF ACTIVE NESTS ARE PRESENT. IF THE SURVEY DETECTS NESTING ACTIVITY, THE FOLLOWING STEPS MUST BE TAKEN TO AVOID NEST DESTRUCTION AND TAKE, WHICH IS A VIOLATION OF STATE LAW:
 1. ONLY PERFORM CONSTRUCTION ACTIVITIES FROM AUGUST 2 TO APRIL 14.
 2. OR IF CONSTRUCTION CANNOT BE PERFORMED FROM AUGUST 2 TO APRIL 14, A DETERRENT SUCH AS MESH NETTING MUST BE USED TO BLOCK ACCESS TO NESTING SITES ON THE UNDERSIDE OF THE BRIDGE(S) IN ACCORDANCE WITH SPECIAL PROVISION #763623 - NETTING MIGRATORY BIRD EXCLUSION. THE MATERIAL WOULD NEED TO BE IN PLACE NO LATER THAN APRIL 14, THE UNDERSIDE OF THE BRIDGE(S) WOULD NEED TO BE FULLY ENCAPSULATED, AND THE MATERIAL MUST BE LEFT IN PLACE UNTIL CONSTRUCTION BEGINS.

3. CULTURAL RESOURCE ISSUES:

THERE ARE NO CULTURAL RESOURCE CONCERNS WITH THE PROJECT AS CURRENTLY DESIGNED. SHOULD IT BE NECESSARY TO ADD ADDITIONAL ACCESS LOCATIONS OR STAGING/STOCKPILING AREAS OUTSIDE OF THE LIMITS OF CONSTRUCTION (LOC), OR OTHERWISE MODIFY THE LOC OR PROJECT SCOPE FROM WHAT IS DETAILED IN THE APPROVED PLANS, DELDOT ENVIRONMENTAL STUDIES STAFF (DOT_ENVIRONMENTALSTUDIES@DELAWARE.GOV, (302) 760-4887) MUST BE CONTACTED TO REVIEW THESE CHANGES FOR POTENTIAL CULTURAL RESOURCES CONCERNS AND COORDINATE WITH THE DE STATE HISTORIC PRESERVATION OFFICE AS NECESSARY.

4. STREAM RESTORATION AND RIPRAP TREATMENT:

- A. FOLLOW THE SPEC FOR ITEM 707021 - CHANNEL BED FILL IN REGARDS TO THE SALVAGING OF ON-SITE NATURAL STREAM BOTTOM MATERIAL OR THE FURNISHING OF OFFSITE MATERIAL. IF SUFFICIENT SOURCES FOR CHANNEL BED FILL DO NOT EXIST ON-SITE, ANY NEW MATERIAL MUST CONFORM TO THE REQUIREMENTS OF ITEM 707021 - CHANNEL BED FILL. RECESS ALL RIPRAP IN THE CHANNEL BOTTOM (I.E. BELOW THE WATER LINE) ONE FOOT BELOW STREAM BED ELEVATION AND CHOKE WITH BORROW TYPE 'B' SO THAT ALL OF THE VOIDS IN THE RIPRAP ARE FILLED WITH SPECIFIED MATERIAL. PAYMENT UNDER ITEM 209002 - BORROW, TYPE B, COVER THE RIPRAP WITH A MINIMUM OF 12" CHANNEL BED FILL. MATCH THE FINAL CHANNEL ELEVATIONS WITH EXISTING ELEVATIONS AT THE UPSTREAM AND DOWNSTREAM PROJECT LIMITS. THROUGH THE STRUCTURE, ELEVATIONS WILL BE AS NOTED ON THE PLANS. PAYMENT UNDER ITEM 707021 - CHANNEL BED FILL.
- B. RESTORE OTHER AREAS OF THE CHANNEL BOTTOM AFFECTED BY CONSTRUCTION (INCLUDING, BUT NOT LIMITED TO, THE LOCATION OF SUMP PITS, STABILIZED OUTFALLS, TEMPORARY PIPES AND/OR SANDBAG DIKES AND DIVERSIONS) TO EXISTING CONDITIONS. FILL ANY CAVITIES OR SCOUR HOLES RESULTING FROM CONSTRUCTION ACTIVITIES WITH CHANNEL BED FILL. PAYMENT UNDER ITEM 707021 - CHANNEL BED FILL.
- C. WHEN ALL EROSION AND SEDIMENT CONTROL MEASURES ARE REMOVED AND THE STREAM RETURNS TO ITS NATURAL FLOW CONDITIONS, THE FLOW MUST REMAIN ABOVE GROUND AND ABOVE THE RIPRAP (I.E. THE FLOW CANNOT BE "LOST" IN THE RIPRAP OR BENEATH THE STRUCTURE). IF THIS IS NOT ACHIEVED, THE CONTRACTOR WILL BE REQUIRED TO TAKE CORRECTIVE ACTION AT THE CONTRACTOR'S EXPENSE.
- D. CHOKE ALL RIPRAP ON THE STREAM BANK, OUTSIDE THE CHANNEL BED, WITH DELAWARE #57 STONE. PLACE JUST ENOUGH CHOKE MATERIAL TO PREVENT THE LOSS OF CHANNEL BED FILL OR TOPSOIL (DEPENDING ON LOCATION AS INDICATED BELOW) THROUGH THE RIPRAP.
 1. BENEATH THE BRIDGE: AFTER PLACING DELAWARE #57 STONE, PERFORM A FINAL CHOKE OF CHANNEL BED FILL SO THAT THE RIPRAP PEAKS ARE BARELY VISIBLE. PAYMENT UNDER ITEM 707021 - CHANNEL BED FILL. DELAWARE #57 STONE IS INCIDENTAL TO THE RIPRAP ITEM.
 2. ALL OTHER LOCATIONS: FINISH FILLING THE VOIDS WITH TOPSOIL SO THAT THE RIPRAP PEAKS ARE BARELY VISIBLE. PLACE AN ADDITIONAL 6-INCH TOPSOIL LAYER ON TOP OF THE RIPRAP. SLOPE SEEDING WILL BE DONE WITH ITEM 908019 - PERMANENT GRASS SEEDING, STREAMBANK. FOLLOWING THE SEEDING OPERATION, INSTALL ITEM 908020 - EROSION CONTROL BLANKET (ECB) MULCH, OR OTHER BLANKET AS SHOWN ON THE PLANS. ECB AT TOE OF SLOPE CAN BE EITHER TRENCHED IN OR STAPLED AT 6" ON CENTER. COMPLETE ALL WORK, STARTING WITH THE INITIAL CHOKING WITH TOPSOIL THROUGH THE SEEDING AND MULCHING PRIOR TO ANY RAIN EVENT. DELAWARE #57 STONE IS INCIDENTAL TO THE RIPRAP ITEM. ALL OTHER ITEMS WILL BE PAID FOR UNDER THEIR RESPECTIVE ITEMS.
- E. THE TOPSOIL/SEED/MULCH CAN BE PLACED BEFORE OR AFTER THE REMOVAL OF THE STREAM DIVERSION. IF THE PLACEMENT OCCURS AFTER STREAM DIVERSION REMOVAL, USE A TURBIDITY CURTAIN TO MINIMIZE IN-STREAM SEDIMENTATION. PAYMENT WILL BE INCIDENTAL TO ITEM 909005 - STREAM DIVERSION.

5. PROTECTION OF RESOURCES:

- A. KEEP CLEARING IN WETLAND AREAS TO A MINIMUM ABSOLUTELY NECESSARY FOR CONSTRUCTION ACCESS. SUPPORT ALL EQUIPMENT TRAVERSING WETLANDS AND SUBAQUEOUS LAND ON MATS. PAYMENT FOR MATS WILL BE MADE UNDER ITEM 621500 - TEMPORARY TIMBER MAT. IN WETLAND AREAS THAT ARE CLEARED, NO GRUBBING EXCEPT WHERE NECESSARY TO CONSTRUCT PROJECT COMPONENTS SUCH AS FOUNDATIONS AND RIPRAP PROTECTION IS PERMITTED. CUT VEGETATION FLUSH WITH THE GROUND (I.E. NO DISTURBANCE OF THE ROOT MAT). RESTORE TEMPORARILY DISTURBED WETLAND AREAS TO GRADE AND SEED WITH ITEM 908017 - TEMPORARY GRASS SEEDING (ANNUAL RYEGRASS).
- B. USE SILT FENCE OR CONSTRUCTION SAFETY FENCE ALONG THE LIMITS OF CONSTRUCTION IN ALL AREAS WHERE WATER WETLANDS ARE BEING IMPACTED (AS SHOWN ON ENVIRONMENTAL COMPLIANCE SHEETS), AND ALSO IN ANY AREA WHERE WATER/WETLANDS EXIST WITHIN 20 FEET OF THE LIMIT OF CONSTRUCTION (AS SHOWN ON CONSTRUCTION PLAN SHEETS). ANY CONTRACTOR ACCESS BEYOND THE LIMIT OF CONSTRUCTION IS STRICTLY PROHIBITED.
- C. USE SANDBAGS OR COMPOST FILTER LOG (CFL) TO SECURE SILT FENCE AT AREAS ADJACENT TO WOODED UPLANDS/ ALL WETLANDS IN LIEU OF TRENCHING UNLESS PROPER EROSION AND SEDIMENT CONTROL CANNOT BE MAINTAINED. REMOVE SANDBAGS AND CFLS (AND CONTENTS) IN THEIR ENTIRETY WHEN NO LONGER NEEDED. SANDBAGS/CFLS USED TO SECURE THE SILT FENCE IS INCIDENTAL TO ITEM 905001 - SILT FENCE. THE ENVIRONMENTAL STUDIES SECTION (302-760-2259 OR DOT_ENVIRONMENTALSTUDIES@DELAWARE.GOV) CAN PROVIDE FURTHER GUIDANCE REGARDING THIS METHOD OF INSTALLATION.
- D. CLEARLY MARK ALL TREES TO BE REMOVED WITH PAINT PRIOR TO THE EROSION AND SEDIMENT CONTROL MEETING.

6. PLANTING GUIDANCE, WORK DONE BY DELDOT:

PLANTING GUIDANCE (INFORMATION ONLY, WORK TO BE DONE BY OTHERS. THERE WILL BE NO PAYMENT FOR PLANTING ON THIS CONTRACT.) UPON FINAL ACCEPTANCE OF THE CONTRACT, NOTIFY THE ENVIRONMENTAL STUDIES SECTION (302-760-2259 OR DOT_ENVIRONMENTALSTUDIES@DELAWARE.GOV) AND ROADSIDE ENVIRONMENTAL (DARIN CALLAWAY, 302-760-2186) OF COMPLETION. PLANT APPROPRIATE TREES AND/OR SHRUBS IN A NATURALIZED PATTERN (MINIMUM 8", MAXIMUM 12" CENTERS) IN TEMPORARILY DISTURBED WOODED WETLAND AREAS WITHIN THE LOC. FINAL PLANT COUNTS WILL BE BASED ON FIELD CONDITIONS AND DETERMINED BY THE ROADSIDE ENVIRONMENTAL ADMINISTRATOR OR APPOINTED DESIGNEE. SPECIFIC PLANT SELECTION IS ALSO AT THEIR DISCRETION BUT MUST BE A NATIVE SPECIES APPROVED BY THE DELAWARE DEPARTMENT OF NATURAL RESOURCES. ON THIS PROJECT, DNREC WLSL REQUIRES THAT A PLANTING PLAN BE SUBMITTED FOR APPROVAL PRIOR TO ACTUAL WORK.

ORIGINAL SHEET PREPARED BY MICHAEL HADDAD ON 4/2/2024. SHEET LAST UPDATED ON 5/23/2025.

WETLANDS DELINEATED BY VAN ADAMS AND TREVOR MCCOLLEY ON 07-13-2023 IN ACCORDANCE WITH THE US ARMY CORPS OF ENGINEERS "CORPS OF ENGINEERS WETLAND DELINEATION MANUAL (1987)".

ADDENDA / REVISIONS

NOT TO SCALE

**PAVEMENT & REHABILITATION,
SUSSEX I, (HARDSCRABBLE &
CONCORD), 2025**

CONTRACT	BRIDGE NO.	3-243
T202506301	DESIGNED BY:	M. HADDAD
COUNTY	CHECKED BY:	S. RODRIGUEZ
SUSSEX		

**ENVIRONMENTAL
COMPLIANCE NOTES**

SECTION
BR
SHEET NO.
09

LEGEND	
	PERMANENT IMPACT AREA
	TEMPORARY IMPACT AREA
	ORDINARY HIGH WATER
	ORDINARY HIGH WATER / WETLAND
	WETLAND BOUNDARY
	LIMIT OF CONSTRUCTION
	IMPACT AREA TYPE ID. (SEE BELOW)
	IMPACT AREA ID. AND/OR NUMBER
O = OPEN WATER IMPACT	T = TEMPORARY IMPACT
W = WETLAND IMPACT	

PERMANENT OPEN WATER IMPACT AREA SCHEDULE							
ID	IMPACT DESCRIPTION	AREA (SF)	AREA (AC)	VOLUME (CY)	JURISDICTION	LOSS VS. IMPACT	LOSS AREA (AC)
O-1	DOWNSTREAM RIPRAP	212.86	0.0049	23.65	USACE/DNREC	IMPACT	0.00
O-2	UPSTREAM RIPRAP	304.61	0.0070	33.85	USACE/DNREC	IMPACT	0.00
O-3	STRUCTURE CHANNEL RIPRAP	552.71	0.0127	61.41	USACE/DNREC	IMPACT	0.00
TOTAL PERMANENT OPEN WATER IMPACTS		1070.18	0.0246	118.91	USACE/DNREC	IMPACT	0.00

PERMANENT WETLAND IMPACT AREA SCHEDULE							
ID	IMPACT DESCRIPTION	AREA (SF)	AREA (AC)	VOLUME (CY)	JURISDICTION	LOSS VS. IMPACT	LOSS AREA (AC)
W-1	UPSTREAM RIPRAP	12.77	0.0003	1.42	USACE	LOSS	0.0003
TOTAL PERMANENT WETLAND IMPACT AREAS		12.77	0.0003	1.42	USACE	LOSS	0.0003

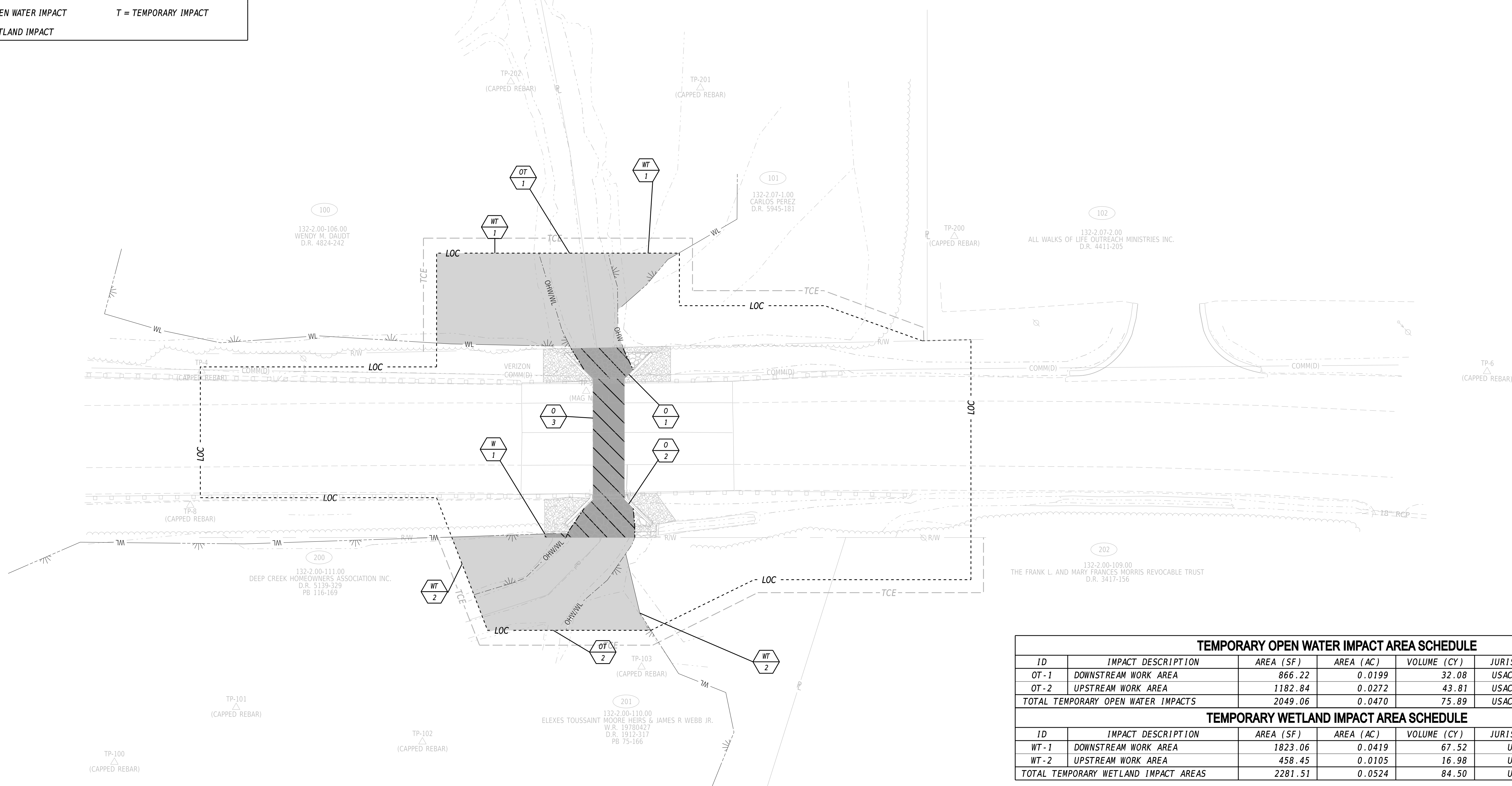

TEMPORARY OPEN WATER IMPACT AREA SCHEDULE					
ID	IMPACT DESCRIPTION	AREA (SF)	AREA (AC)	VOLUME (CY)	JURISDICTION
OT-1	DOWNSTREAM WORK AREA	866.22	0.0199	32.08	USACE/DNREC
OT-2	UPSTREAM WORK AREA	1182.84	0.0272	43.81	USACE/DNREC
TOTAL TEMPORARY OPEN WATER IMPACTS		2049.06	0.0470	75.89	USACE/DNREC

TEMPORARY WETLAND IMPACT AREA SCHEDULE					
ID	IMPACT DESCRIPTION	AREA (SF)	AREA (AC)	VOLUME (CY)	JURISDICTION
WT-1	DOWNSTREAM WORK AREA	1823.06	0.0419	67.52	USACE
WT-2	UPSTREAM WORK AREA	458.45	0.0105	16.98	USACE
TOTAL TEMPORARY WETLAND IMPACT AREAS		2281.51	0.0524	84.50	USACE

16-DEC-2024 17:13 \\srm-del00p021\CS_pdf_work_dir\1349\9634_10\IEC02_BRSE_T202407601_DOT.dgn

ADDENDA / REVISIONS

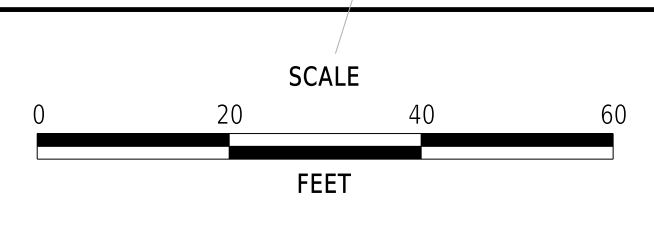

**PAVEMENT & REHABILITATION,
SUSSEX I, (HARDSCRABBLE &
CONCORD), 2025**

CONTRACT	BRIDGE NO.	3-243
T202506301	DESIGNED BY:	M. HADDAD
COUNTY	CHECKED BY:	S. RODRIGUEZ
SUSSEX		

ENVIRONMENTAL COMPLIANCE PLAN	SECTION
	BR
	SHEET NO. 10

GENERAL EROSION AND SEDIMENT CONTROL (E&S) NOTES

1. THE STORMWATER POLLUTION PREVENTION PLAN (SWPPP) HAS BEEN APPROVED BY DELDOT'S STORMWATER ENGINEER UNDER DELDOT'S DELEGATED AUTHORITY. PLAN APPROVAL IS VALID FOR 1 YEAR FOR A STANDARD PLAN. ANY DEVIATIONS TO THE SWPPP NEED APPROVAL FROM THE ENGINEER.

<i>Steven Sison</i>	8/16/2024
DELDOT STORMWATER ENGINEER	DATE
I CERTIFY THAT TO THE BEST OF MY KNOWLEDGE THESE PLANS MEET THE REQUIREMENTS OF THE DELAWARE SEDIMENT AND STORMWATER REGULATIONS.	

AMOUNT OF DISTURBED AREA FOR THE PROJECT	0.25 AC
ADDED IMPERVIOUS FOR THE PROJECT	0.00 SF
HUC-10 WATERSHED	DEEP CREEK

- ASSIGN A RESPONSIBLE PERSON TO BE ON SITE DURING ALL EARTH DISTURBING ACTIVITIES AND BE AN ACTIVE DNREC BLUE CARD HOLDER AS DEFINED IN SECTION 6.2 OF THE DELAWARE SEDIMENT AND STORMWATER REGULATIONS (DSSR). BE FAMILIAR WITH AND COMPLY WITH ALL ASPECTS OF THE NPDES CONSTRUCTION GENERAL PERMIT.
- REVISIONS TO THE SWPPP OR ENVIRONMENTAL COMPLIANCE PLAN SHEET(S) SHALL BE APPROVED PRIOR TO INITIATION IN THE FIELD. THE ENGINEER IS RESPONSIBLE FOR APPROVING ALL REDLINES AND REVISIONS TO THE SWPPP.
- IMPLEMENTING AND MAINTAINING POLLUTION PREVENTION DEVICES AND PRACTICES IS REQUIRED UNDER THE DELAWARE CONSTRUCTION GENERAL PERMIT AND THE DSSR AND ARE INCIDENTAL TO THE CONTRACT.
- A SOIL STOCKPILE, AS DESCRIBED IN DELDOT STANDARD SPECIFICATIONS AND DEFINED IN THE DELAWARE EROSION & SEDIMENT CONTROL HANDBOOK, IS ANY LOCATION WITHIN THE LIMITS OF CONSTRUCTION WHERE A TEMPORARY DEPOSIT OF EXCAVATED SOIL IS BEING RESERVED FOR FUTURE USE. A SOIL STOCKPILE SHALL BE LOCATED A MINIMUM OF 50 FEET FROM A STORM DRAIN INLET, OPEN CHANNEL, WETLAND, OR WATERBODY. A REQUEST MAY BE MADE TO THE ENGINEER TO PERMIT LOCATING A SOIL STOCKPILE LESS THAN 50 FEET FROM A STORM DRAIN INLET OR OPEN CHANNEL. UPON APPROVAL, IF ANY PART OF A SOIL STOCKPILE IS LESS THAN 50 FEET FROM A STORM DRAIN INLET OR OPEN CHANNEL, INSTALL A SUPER SILT FENCE PERIMETER TO PROTECT THE SOIL STOCKPILE. THE SUPER SILT FENCE MUST BE CONSTRUCTED IN ACCORDANCE WITH 905.3.B.3 OF THE STANDARD SPECIFICATIONS. THE COST FOR INSTALLATION AND MAINTENANCE OF THE STOCKPILE SUPER SILT FENCE IS INCIDENTAL TO THE CONTRACT.
- PROTECT AGAINST SEDIMENT OR DEBRIS LADEN RUNOFF FROM LEAVING THE SITE. CHECK PERIMETER CONTROLS DAILY AND ADJUST OR REPAIR TO FULLY CONTAIN AND CONTROL SEDIMENT FROM LEAVING THE SITE. REMOVE ACCUMULATED SEDIMENT BEFORE IT HAS REACHED HALF OF THE EFFECTIVE CAPACITY OF THE CONTROL. ADJUST OR ALTER MEASURES IN TIMES OF ADVERSE WEATHER CONDITIONS, OR AS DIRECTED BY THE ENGINEER.
- ANY SEDIMENT LADEN DISCHARGE LEAVING THE LIMIT OF CONSTRUCTION SHALL IMMEDIATELY BE ADDRESSED THROUGH BEST AVAILABLE TECHNOLOGIES TO CONTROL ANY FURTHER SEDIMENT LADEN DISCHARGE. REMEDIATION MAY INCLUDE STANDARD E&S PRACTICES OR OTHER METHODS AS APPROVED BY THE ENGINEER.
- ALL TEMPORARY CONCENTRATED FLOW AREAS INCLUDING CHANNEL SIDE SLOPES SHALL HAVE EROSION CONTROL BLANKET MULCH AS DIRECTED BY THE ENGINEER. INSTALL WITHIN SEVEN CALENDAR DAYS UPON CONSTRUCTION INITIATION. A TEMPORARY CONCENTRATED FLOW AREA MAY INCLUDE DITCHES, SWALES, BERMS, CONCENTRATED RUNOFF AREAS, ETC.
- MAINTAIN POSITIVE DRAINAGE IN EXISTING AND PROPOSED DRAINAGE SYSTEMS BY EXECUTING CONSTRUCTION, CLEANING EXISTING DRAINAGE SYSTEMS, AND PROPERLY DISPOSING OF SEDIMENT THROUGHOUT THE DURATION OF THE PROJECT.
- PER MINOR BRIDGE AND CULVERT CONSTRUCTION STANDARD PLAN APPROVAL, THE TOTAL DISTURBED AREA FOR CONSTRUCTION OF THE IMPROVEMENTS NOT EXCEED 1.0 ACRE.

MAINTENANCE OF TRAFFIC (MOT) NOTES

1. AMERICAN TRAFFIC SAFETY SERVICES ASSOCIATION (ATSSA) CERTIFIED TRAFFIC CONTROL SUPERVISOR REQUIREMENT FOR THIS PROJECT.

()	THE CONTRACTOR SHALL NOT BE REQUIRED TO HAVE AN ATSSA SUPERVISOR ASSIGNED TO THIS PROJECT.
(X)	THE CONTRACTOR SHALL HAVE AN ATSSA SUPERVISOR ASSIGNED TO THIS PROJECT AND THAT PERSON'S SOLE RESPONSIBILITY SHALL BE THE MANAGEMENT AND SUPERVISION OF THE PROJECT'S TEMPORARY TRAFFIC CONTROL ACTIVITIES. THIS PERSON SHALL NOT HAVE ANY OTHER ROLE ON THE PROJECT. RESPONSIBILITIES AND REQUIREMENTS OF THE ATSSA SUPERVISOR ARE DEFINED IN SECTION 812 OF THE STANDARD SPECIFICATIONS. PAYMENT FOR ATSSA SUPERVISOR IS INCIDENTAL TO ITEM 801500.

2. THE USE OF MILLINGS AND GRADED AGGREGATE BASE COURSE (GABC) IN THE TRAVEL WAY, TEMPORARY TRAVEL WAY, HIGH VOLUME ENTRANCES AND ACCESS RAMP FOR THE PURPOSE OF PROVIDING A TEMPORARY ROADWAY SURFACE, POTHOLE REPAIR, TAPERED EDGE FOR UTILITIES, BUTT JOINTS, AND LONGITUDINAL DROP-OFFS (MILLING AND PAVING OPERATIONS) IS PROHIBITED UNLESS IT IS OTHERWISE DESIGNATED TO BE USED IN THE CONTRACT PLANS. USE COLD PATCH, BITUMINOUS CONCRETE, BITUMINOUS CONCRETE WEDGE, OR TAPER MILL, AS NOTED IN THE CONTRACT DOCUMENTS OR APPROVED BY THE ENGINEER. PAYMENT FOR COLD PATCH, BITUMINOUS CONCRETE OR BITUMINOUS CONCRETE WEDGE SHALL BE PAID AS NOTED IN THE CONTRACT DOCUMENTS. TAPER MILL BITUMINOUS CONCRETE SHALL BE PAID UNDER THE BITUMINOUS CONCRETE MILLING ITEM.

MILLINGS OR GABC SHALL BE USED AT THE FOLLOWING LOCATIONS WHERE ACCESS TO A BUSINESS, RESIDENCE, OR EDGE DROP OFF NEEDS TO BE MAINTAINED UNLESS OTHERWISE NOTED IN THE PLANS OR DIRECTED BY THE ENGINEER TO USE BITUMINOUS CONCRETE OR COLD PATCH. ALL MILLINGS AND GABC WILL BE ROLLED AND COMPACTED TO HELP PREVENT THE MATERIAL FROM UNRAVELLING:

- DRIVEWAYS
- ENTRANCES
- LOW VOLUME ACCESS RAMPS (IDENTIFIED IN THE CONTRACT DOCUMENTS)
- EDGE DROP-OFFS ADJACENT TO LIVE ROADWAY (LANES AND SHOULDER) AND THE PROPOSED ROAD CONSTRUCTION
- EDGE OF ROADWAY DROP-OFF

GRADING AND MAINTAINING BASE COURSE THAT IS BEING USED FOR ROADWAY WEDGE/FILLET BETWEEN TRAVEL LANES AND PAVEMENT BOX, EDGE OF TRAVELWAY, DRIVEWAY OR ENTRANCE ACCESS SHALL BE INCIDENTAL TO ITEM NO. 801500 - MAINTENANCE OF TRAFFIC, ALL INCLUSIVE. THE BASE COURSE MATERIAL SHALL BE PLACED AT NO GREATER THAN THE SLOPE SPECIFIED IN TABLE 6G-1 AND SHALL BE COMPACTED. EXCESS BASE COURSE MATERIAL SHALL BE PUSHED AHEAD AND USED IN THE NEXT SEGMENT AND SHALL BE INCIDENTAL TO THE PARTICULAR BASE COURSE PAY ITEM. NO SEPARATE PAYMENT SHALL BE MADE FOR MILLINGS OR GABC TEMPORARY ROADWAY MATERIAL (TRM) USED TO PROTECT EDGE DROP-OFFS, UNLESS THE MATERIAL IS EVENTUALLY UTILIZED AS PART OF A PERMANENT ROADWAY AT WHICH TIME THE MATERIAL WOULD BE PAID FOR UNDER THE RESPECTIVE CONTRACT MATERIAL ITEM.

VERTICAL DIFFERENCES SHALL BE CORRECTED IN ACCORDANCE WITH TABLE 6G-1 OF THE DELAWARE MUTCD.

3. ALL NECESSARY SIGNS, PAVEMENT MARKINGS AND ROADSIDE APPURTENANCES SHALL BE INSTALLED PRIOR TO THE OPENING/REOPENING OF A ROADWAY OR RAMP. A WALKTHROUGH WITH THE ENGINEER, TRAFFIC SAFETY, TRAFFIC CONSTRUCTION AND OTHER PERSONNEL SHALL OCCUR NO LESS THAN 48 HOURS PRIOR TO THE OPENING/REOPENING OF ANY ROAD OR RAMP.

NOTE:

1. IF STREAM DIVERSION PIPE IS ATTACHED TO THE INTERIOR OF THE CULVERT, SUBMIT METHOD OF ATTACHMENT TO THE ENGINEER FOR APPROVAL.

SEQUENCE OF CONSTRUCTION (SOC)

- INSTALL MOT DEVICES IN ACCORDANCE WITH THE DETOUR PLAN.
- INSTALL SILT FENCE (ITEM 905001) AND COMPOST FILTER LOG (ITEM 907017) EXCEPT CONNECTION TO SANDBAG DIKES.
- INSTALL STILLING WELL (INCIDENTAL TO ITEM 909005) JUST UPSTREAM OF THE PROPOSED UPSTREAM SANDBAG DIKE. PLACE R-5 RIPRAP (INCIDENTAL TO ITEM 909005) 5 FEET IN DIRECTION OF FLOW BY 5 FEET WIDE AT THE PROPOSED DISCHARGE AREA.
- CONSTRUCT THE SANDBAG DIKE, AT THE LOCATION SHOWN, WITH TOP EL. OF 1.55 OR 6 INCHES BELOW TOP OF STREAM BANK (WHICHEVER IS LOWER) WITH A 12' WIDE x 1.25' DEEP WEIR OPENING UPSTREAM. ELEVATION OF THE DOWNSTREAM SANDBAG DIKE SHALL NOT BE HIGHER THAN THE LOWEST ELEVATION ON THE UPSTREAM SANDBAG DIKE. CONNECT SILT FENCE TO THE SANDBAG DIKE TO COMPLETELY ENCLOSE THE WORK AREA. USE PUMP (INCIDENTAL TO ITEM 909005) TO DIVERT THE STREAM BASE FLOW AROUND THE ENCLOSED WORK AREA. WHEN THE FLOW IS HIGHER THAN PUMP CAPACITY DURING RAINFALL EVENTS, THE STREAM FLOW IS ALLOWED TO FLOW OVER THE SANDBAG DIKE. THEREFORE, THE ENCLOSED AREA SHALL BE KEPT CLEAR OF DEBRIS AND OBSTRUCTIONS AT THE END OF EACH WORKDAY. THE BASE FLOW THROUGH THE PUMP(S) SHALL BE 30.00 C.F.S.
- INSTALL SUMP PIT (ITEM 906003) AND DEWATERING BAG (ITEM 906002) AS A SEDIMENT TRAPPING DEVICE. DEWATER THE WORK AREA IN ACCORDANCE WITH SECTION 902 OF THE STANDARD SPECIFICATIONS. DISCHARGE CLEAN EFFLUENT FROM THE APPROVED SEDIMENT TRAPPING DEVICE AT THE STABILIZED OUTLET OF THE PUMPING OPERATION OR ON OTHER STABLE OUTLET AS APPROVED BY THE ENGINEER.
- COMPLETE ALL PROPOSED WORK.
- REMOVE TEMPORARY EROSION AND SEDIMENT CONTROL DEVICES AFTER VEGETATION HAS STABILIZED ALL DISTURBED AREAS IN ACCORDANCE WITH THESE PLANS AND AS DIRECTED BY THE ENGINEER.
- REMOVE ALL MOT DEVICES AND REOPEN THE ROADWAY. REMOVAL OF MOT DEVICES MAY OCCUR PRIOR TO REMOVAL OF TEMPORARY EROSION AND SEDIMENT CONTROL DEVICES.

EROSION & SEDIMENT CONTROL	
	COMPOST FILTER LOG
	COMPOST FILTER LOG / LENGTH
	DEWATERING BAG
	DEWATERING BASIN
	EARTH DIKE
	INLET SEDIMENT CONTROL
	PERIMETER DIKE/SWALE
	PORTABLE SEDIMENT TANK
	SANDBAG DIKE
	SANDBAG DIVERSION
	STONE CHECK DAM
	STABILIZED CONSTRUCTION ENTRANCE
	SILT FENCE / LENGTH
	SILT FENCE
	REINFORCED SILT FENCE / LENGTH
	REINFORCED SILT FENCE
	SUPER SILT FENCE / LENGTH
	SUPER SILT FENCE
	SUMP PIT
	SEDIMENT TRAP / NUMBER
	SEDIMENT TRAP
	SEDIMENT TRAP WITH INLET AS OUTLET
	SEDIMENT TRAP PIPE OUTLET
	STILLING WELL
	TEMPORARY SWALE
	TEMPORARY SLOPE DRAIN
	TURBIDITY CURTAIN / LENGTH
	TURBIDITY CURTAIN
CONSTRUCTION PHASING & M.O.T	
	BARRICADE, TYPE 3
	CONCRETE SAFETY BARRIER - PORTABLE
	CONSTRUCTION SAFETY FENCE / LENGTH
	CONSTRUCTION SAFETY FENCE
	CONSTRUCTION WARNING SIGN LOCATION
	CONSTRUCTION WARNING SIGN
	CRASH CUSHION ARRAY
	DRUM - TRAFFIC CONTROL
	FLAGGER LOCATION
	PHASING TRAFFIC FLOW ARROW
	TEMPORARY CONSTRUCTION
	TEMPORARY PAVEMENT MARKING ARROW
	TRUCK WITH MOUNTED ATTENUATOR
	WORK AREA - ACTIVE PHASE

26-MAR-2025 10:18 \\fs1m-deloopw21\CS1_paf_work_dir\3021\9634_12\CS01_BRSE_T202407601_DOT.dgn

ADDENDA / REVISIONS		NOT TO SCALE	PAVEMENT & REHABILITATION, SUSSEX I, (HARDSCRABBLE & CONCORD), 2025	CONTRACT	BRIDGE NO.	3-243	CONSTRUCTION PHASING, M.O.T., AND EROSION CONTROL NOTES	SECTION
				T202506301	DESIGNED BY: M. HADDAD			BR
				COUNTY	CHECKED BY: S. RODRIGUEZ			SHEET NO.
				SUSSEX				11

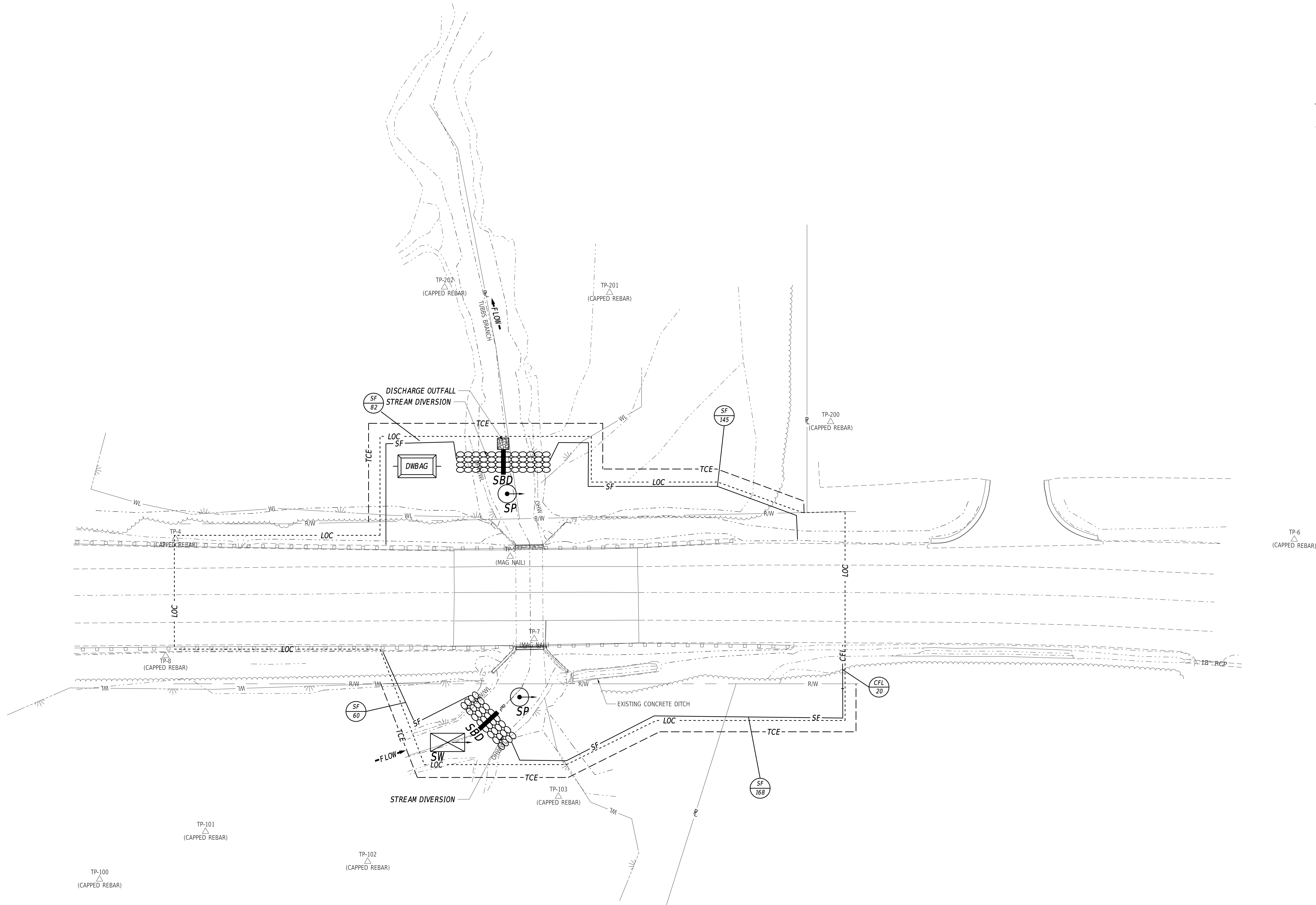
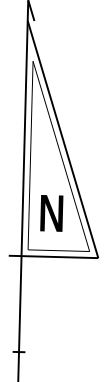

16-DEC-2024
 17:13
 \\srm-delco\pww\1\CS_paf_work_dir\1349\9634_13\CS02_BRSE_T202407601_DOT.dgn

ADDENDA / REVISIONS	

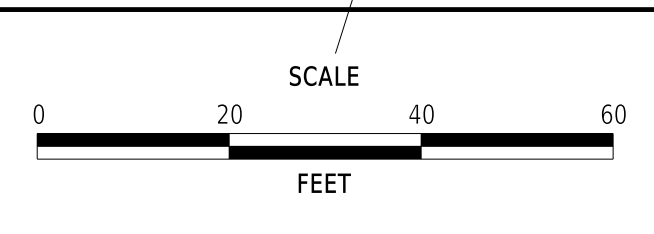

**PAVEMENT & REHABILITATION,
SUSSEX I, (HARDSCRABBLE &
CONCORD), 2025**

CONTRACT	BRIDGE NO.	3-243
T202506301	DESIGNED BY:	M. HADDAD
COUNTY	CHECKED BY:	S. RODRIGUEZ
SUSSEX		

CONSTRUCTION PHASING, M.O.T., AND EROSION CONTROL PLAN
SECTION
BR
SHEET NO.
12

PORTABLE CHANGEABLE MESSAGE SIGNS

PRIOR TO DETOUR
(10 DAYS PRIOR TO BEGINNING OF DETOUR)

PCMS-1

**SR 20
TO CLOSE**

**STARTING
XX/XX/XX**

SPECIAL SIGNS

*RETROREFLECTIVE PRISMATIC FLUORESCENT
ORANGE BACKGROUND; BLACK LEGEND

*ROUTE SHIELD - WHITE BACKGROUND; BLACK
LEGEND

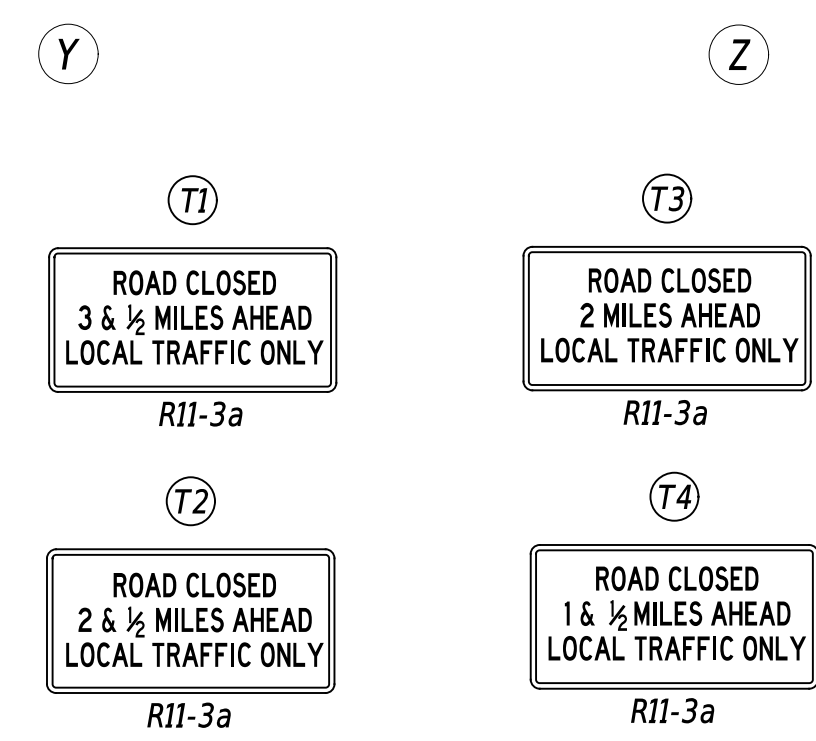
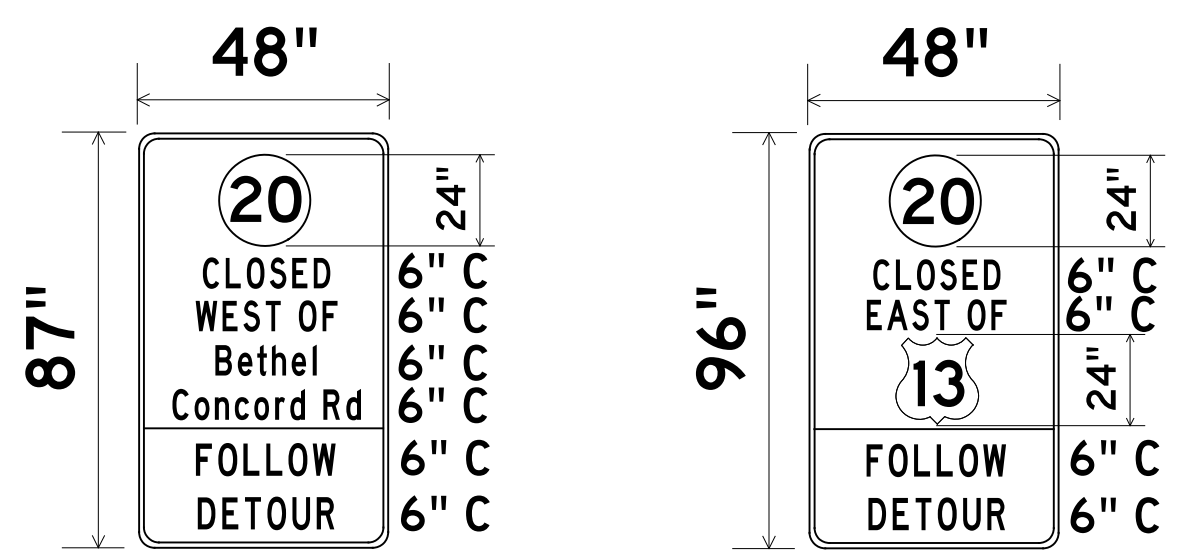

PREPARED BY
DELDOT - TRANSPORTATION SOLUTIONS
TRAFFIC SAFETY

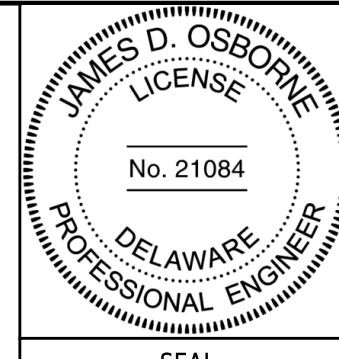

THIS SEAL ONLY APPLIES TO THIS DETOUR SHEET
DATE: 08/22/2024

QA/QC REVIEWER: Justin D. ... DATE: 08/21/2024

I CERTIFY TO THE BEST OF MY KNOWLEDGE AND BELIEF THAT THIS DETOUR PLAN HAS BEEN PREPARED IN ACCORDANCE WITH THE DELAWARE MANUAL ON UNIFORM TRAFFIC CONTROL DEVICES.

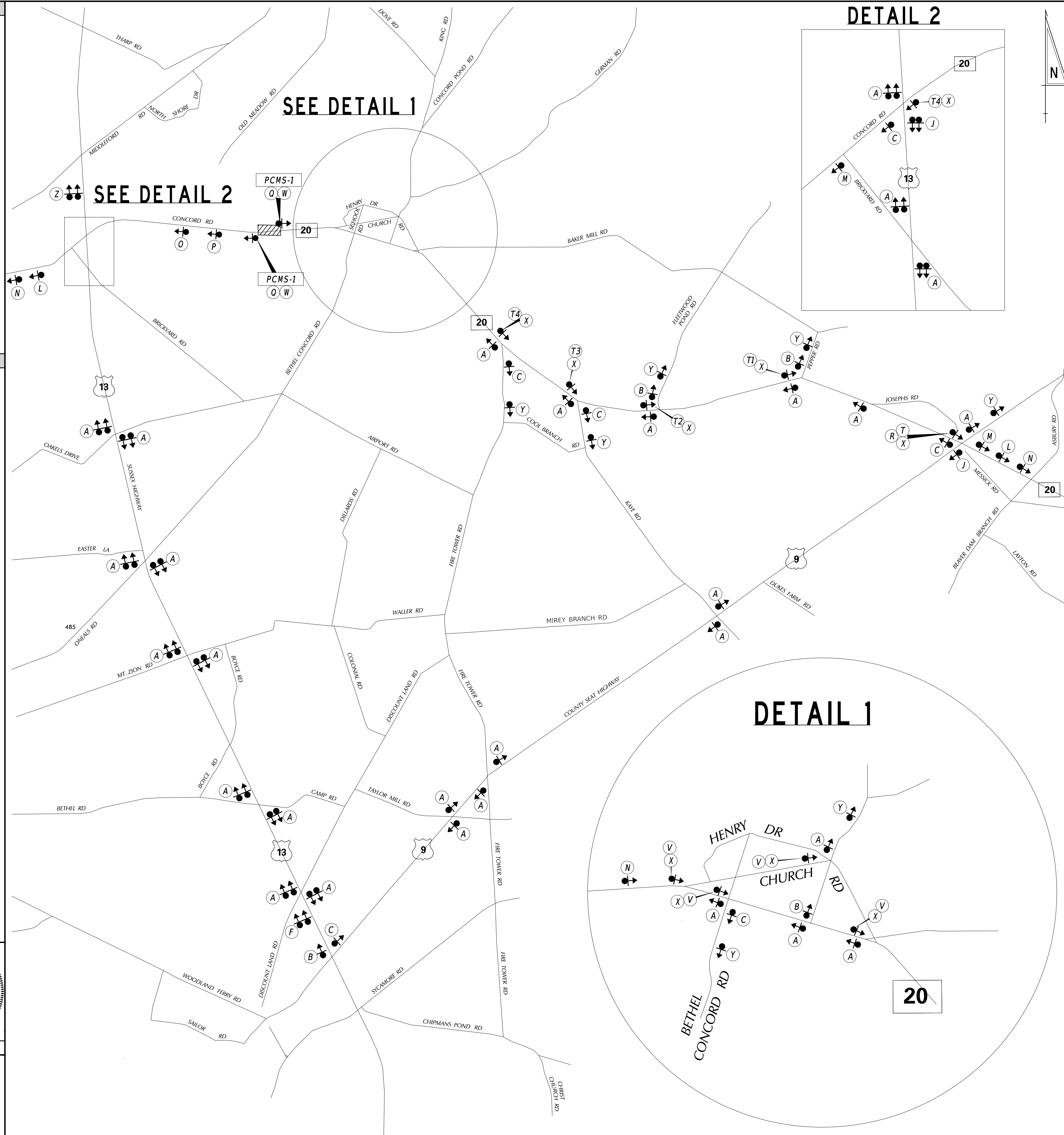

DETAIL 2

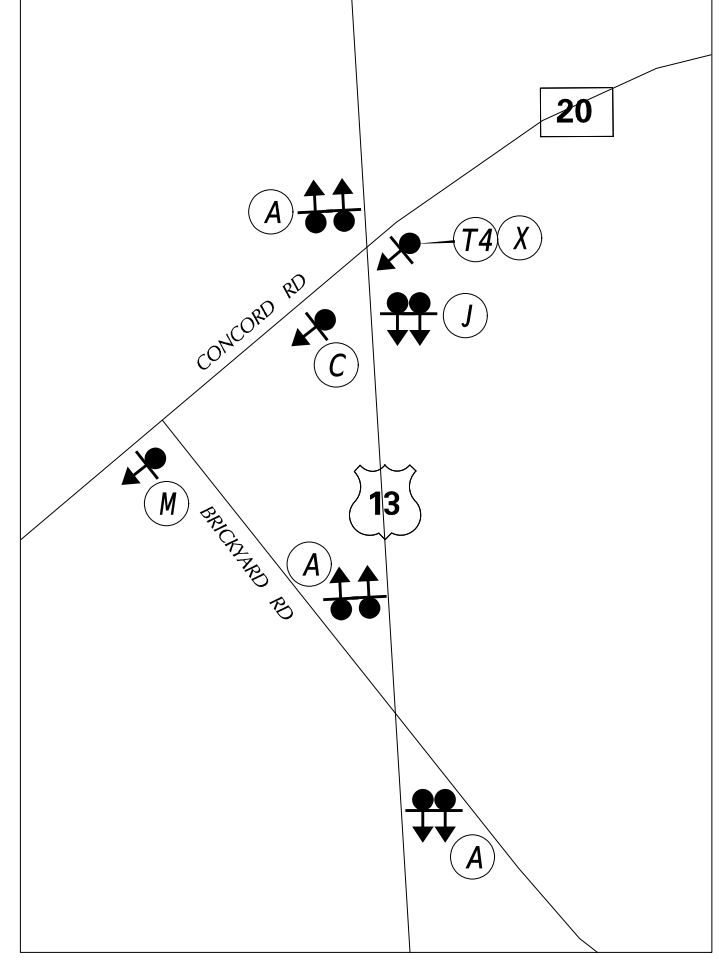

DETAIL 1

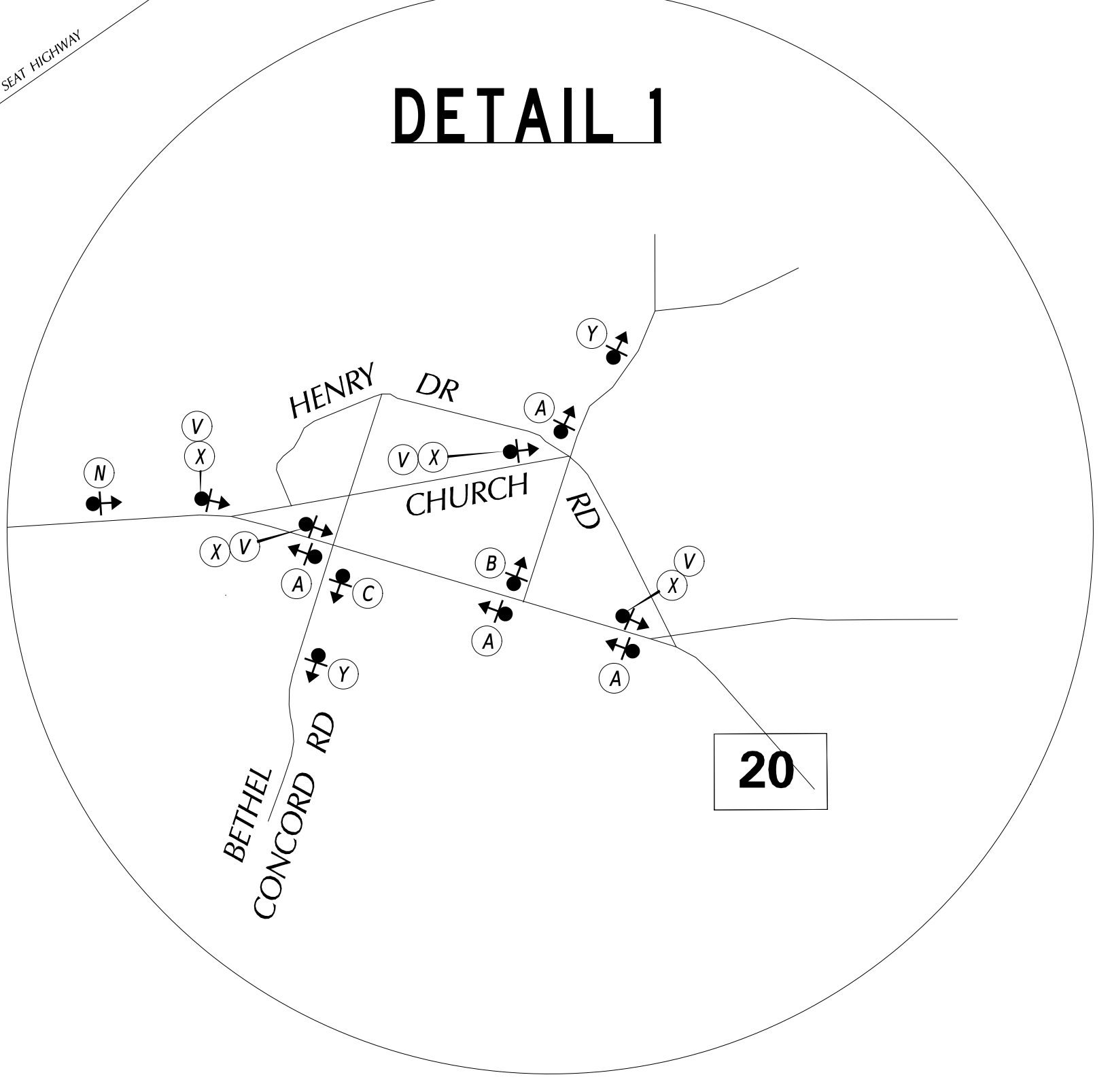

LEGEND

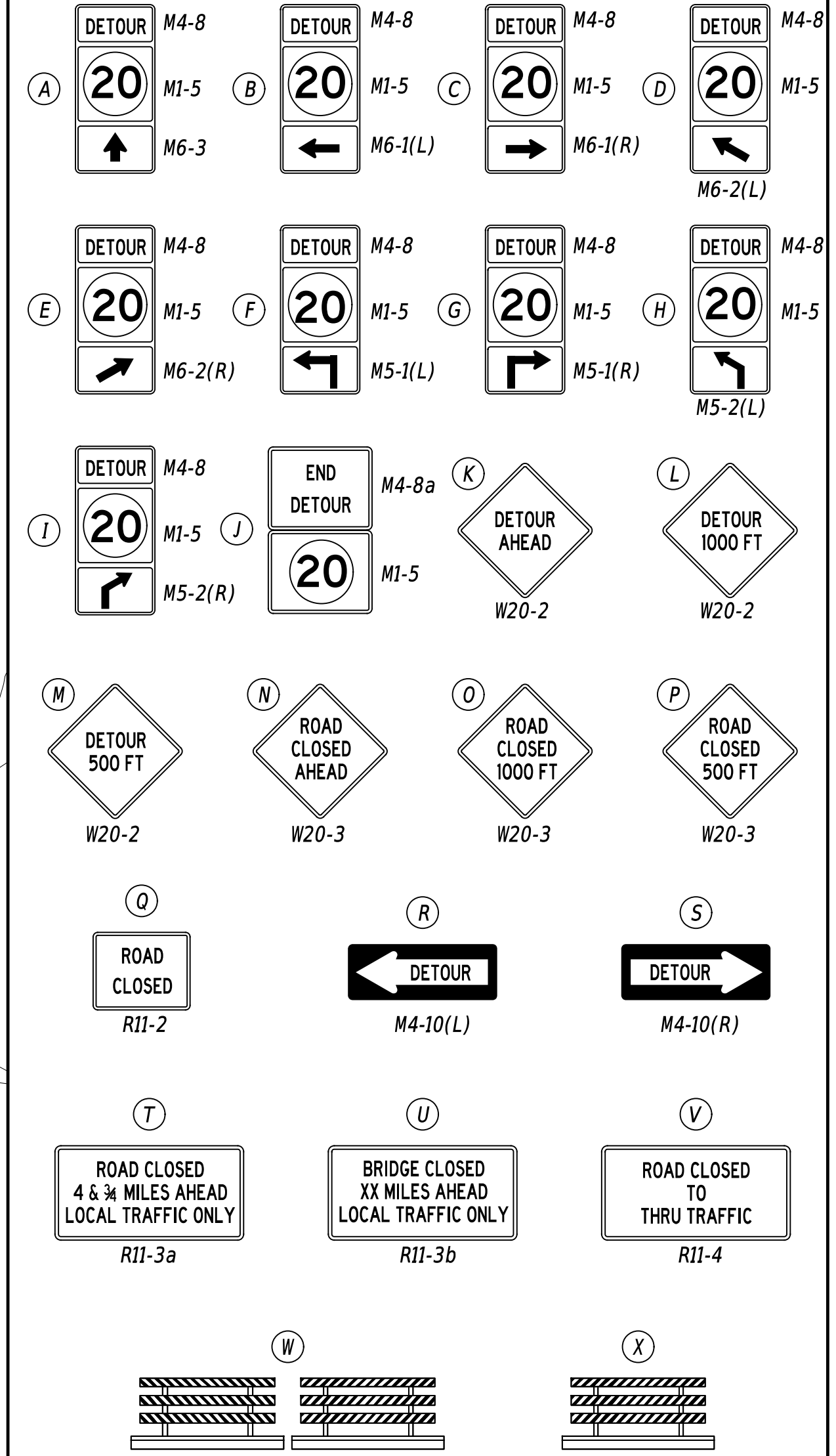

GENERAL NOTES

- ALL TEMPORARY TRAFFIC CONTROL DEVICES ARE TO BE SUPPLIED AND MAINTAINED BY THE GENERAL CONTRACTOR AND SHALL BE IN COMPLIANCE WITH THIS PLAN AND THE DELAWARE MANUAL ON UNIFORM TRAFFIC CONTROL DEVICES (DE MUTCD) LATEST EDITION.
 - SIGNS "N" THROUGH "Q" AND "T" AND "V", THE WORD "ROAD" SHALL BE CHANGED TO "RAMP", "RR XING" OR "BRIDGE" WHERE APPLICABLE.
 - "W" TYPE 3 BARRICADES AT A ROAD CLOSURE SHALL BE PLACED COMPLETELY ACROSS THE ROADWAY, FROM CURB TO CURB, OR FROM EDGE OF ROAD TO EDGE OF ROAD, WITH THE STRIPES POSITIONED DOWNWARD TOWARD THE CENTER OF THE ROADWAY.
 - BARRICADES SHALL BE A MINIMUM OF 6 FEET WIDE UNLESS DIRECTED BY THE ENGINEER.
- DETOUR DESCRIPTION:**
- DRIVERS WANTING TO HEAD WEST ON SR 20 - CONCORD RD WILL GO LEFT ON US 9 - COUNTY SEAT HIGHWAY, THEN RIGHT ON US 13 - SUSSEX HIGHWAY RETURNING TO SR 20 - CONCORD RD.
- DRIVERS WANTING TO HEAD EAST ON SR 20 - CONCORD RD WILL GO RIGHT ON US 13 - SUSSEX HIGHWAY, THEN LEFT ON US 9 - COUNTY SEAT HIGHWAY RETURNING TO SR 20 - CONCORD RD.

CONCURRENCE FOR IMPLEMENTATION

TRAFFIC SAFETY: *James Wynn* DATE: 8/20/2024

ADDENDA / REVISIONS

NOT TO SCALE

**PAVEMENT & REHABILITATION,
SUSSEX I, (HARDSCRABBLE &
CONCORD), 2025**

CONTRACT	BRIDGE NO.	3-243
T202506301	DESIGNED BY:	DBW
COUNTY	CHECKED BY:	JCG
SUSSEX		

**DETOUR PLAN - VEHICULAR
SR20 @ BR 3-243**

SECTION	SAFETY
SHEET NO.	13

PAVEMENT MARKINGS LEGEND		
SYM	ITEM	QUANTITY
(A)	EPOXY RESIN PAINT PAVEMENT STRIPING, YELLOW 6" SOLID DOUBLE LINE (ITEM 861001)	294 LF
(B)	EPOXY RESIN PAINT PAVEMENT STRIPING, WHITE 6" SOLID (ITEM 861001)	588 LF

- NOTES:
 1. ADJUST STRIPING AS NEED TO TIE INTO EXISTING STRIPING.
 2. REPLACE EXISTING RECESSED DELINIATORS IN CENTER LINE (ITEM #867001).

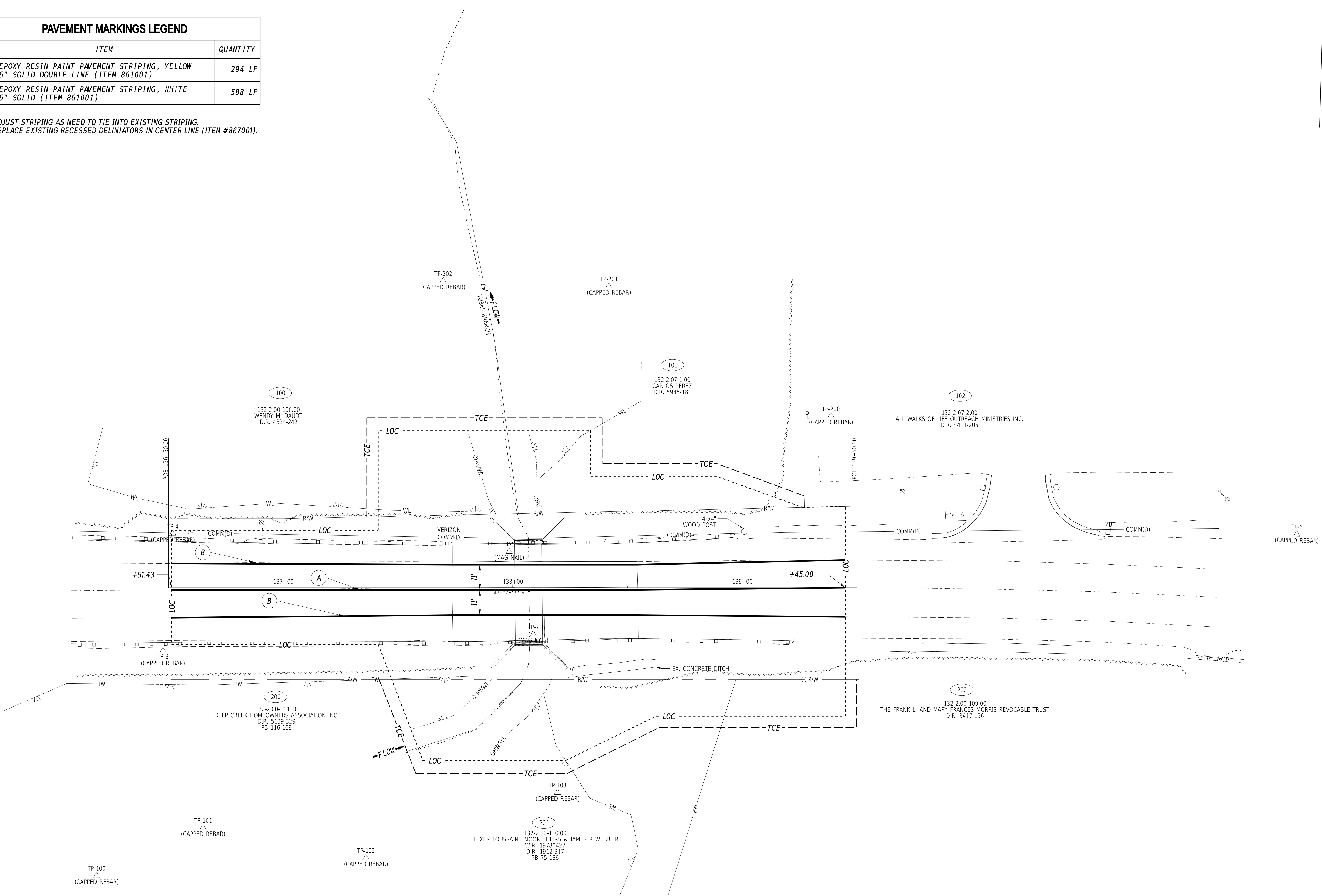

6-FEB-2025 19:49 \\CSW-deltotw\1\CS_pdw\work_dir\217019634_14NS01_LBRSE_T202407601_DOT.dgn

ADDENDA / REVISIONS

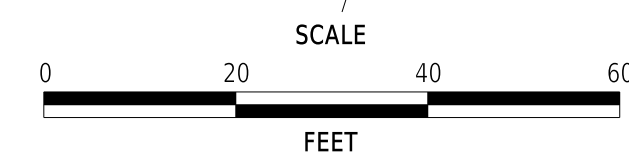

**PAVEMENT & REHABILITATION,
 SUSSEX I, (HARDSCRABBLE &
 CONCORD), 2025**

CONTRACT	BRIDGE NO.	3-243
T202506301	DESIGNED BY:	M. HADDAD
COUNTY	CHECKED BY:	S. RODRIGUEZ
SUSSEX		

**SIGNING, STRIPING
 AND CONDUIT PLAN**

SECTION	BR
SHEET NO.	14

NOTE:
 1. EXISTING RIGHT OF WAY IS SHOWN FOR INFORMATIONAL PURPOSES ONLY PER CONTRACT 64-01-024

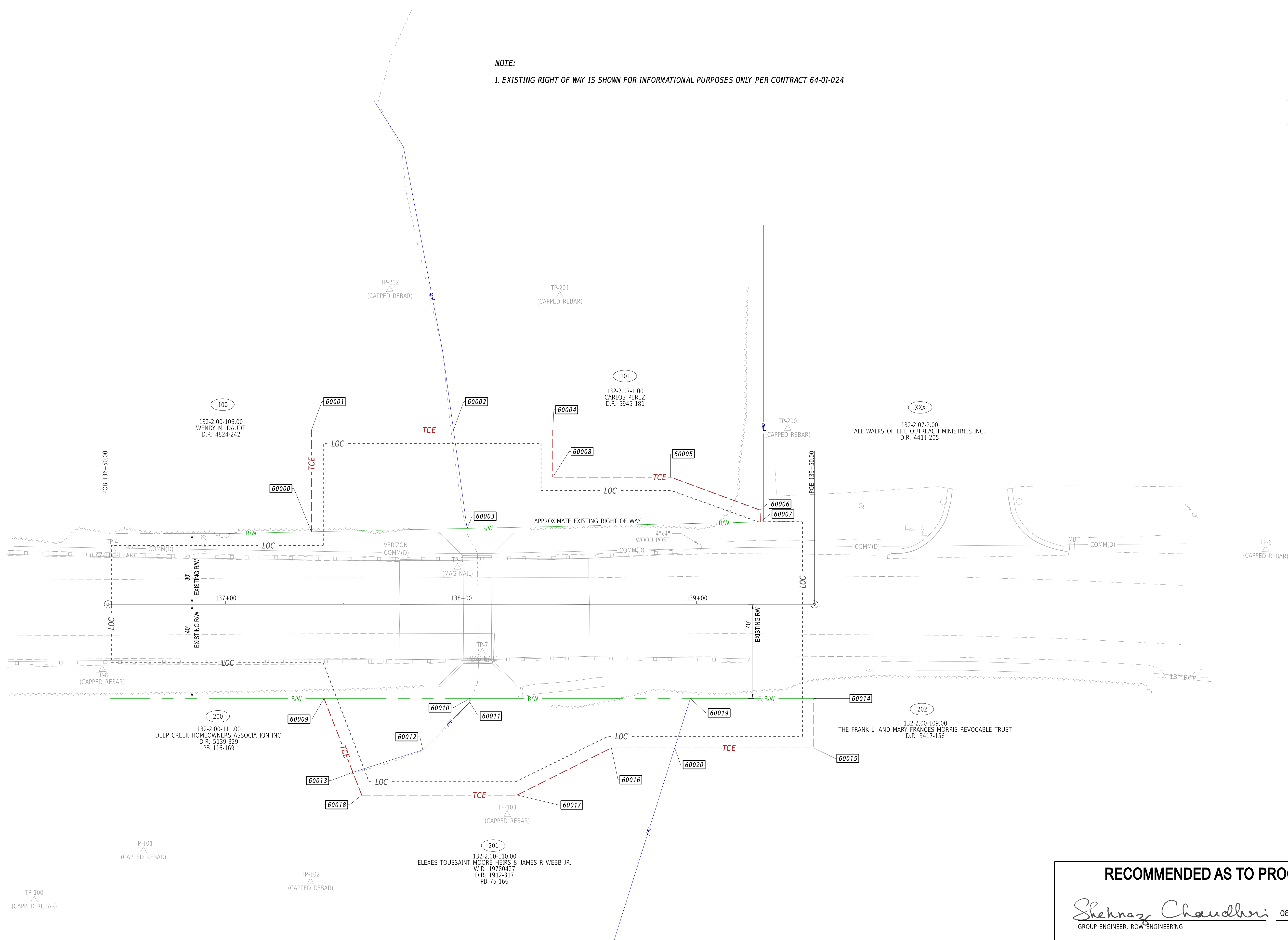

15-AUG-2024 16:31 \\delidpww111cs01\CS_pof_work_gfr\24593\79634_18\RW01_BRSF_T202407601_DOT.dgn

RECOMMENDED AS TO PROCESS

Shehnaz Chaudhri 08/21/2024
 GROUP ENGINEER, ROW ENGINEERING DATE

REVISIONS	

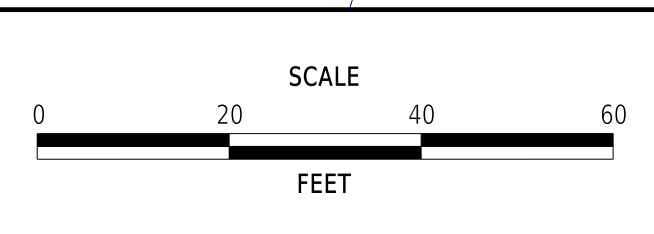

**PAVEMENT & REHABILITATION,
 SUSSEX I, (HARDSCRABBLE & CONCORD), 2025**

CONTRACT T202506301	BRIDGE NO. 3-243	
COUNTY SUSSEX	DESIGNED BY: M. HADDAD	
	CHECKED BY: S. RODRIGUEZ	

RIGHT-OF-WAY PLAN	
SECTION BR	SHEET NO. 15

ASSESSMENT NUMBER		OWNERSHIP OF RECORD						TYPE OF ACQUISITION	TITLE SOURCE	PARCEL AREA (ACRES)	PAGE NUMBER
132-2.00-106.00		(100) WENDY M. DAUDT						TCE	4824-242	D - 15.520	15
PT. NO.	ALIGN. NO.	STATION	OFFSET*	NORTH	EAST	BEARING	DISTANCE	CHORD BEARING	CHORD LENGTH	ARC LENGTH	RADIUS**
60000	1000	137+36.43	-30.792	233496.8389	614069.7890	N 1°30'22" W	43.208				
60001	1000	137+36.43	-74.000	233540.0318	614068.6534	N 88°29'38" E	60.332				
60002	1000	137+96.76	-74.000	233541.6176	614128.9645	S 9°20'54" E	42.165				
60003	1000	138+02.51	-32.229	233500.0126	614135.8135	S 87°14'53" W	66.101				
60000	1000	137+36.43	-30.792	233496.8389	614069.7890						
FIGURE 50000 AREA = 2687.75 SQ. FT. (0.062 ACRES).											
DEED RECORD OF ACQUISITION:											
ASSESSMENT NUMBER		OWNERSHIP OF RECORD						TYPE OF ACQUISITION	TITLE SOURCE	PARCEL AREA (ACRES)	PAGE NUMBER
132-2.07-1.00		(101) CARLOS PEREZ						TCE	5945-181	A - 0.120	15
PT. NO.	ALIGN. NO.	STATION	OFFSET*	NORTH	EAST	BEARING	DISTANCE	CHORD BEARING	CHORD LENGTH	ARC LENGTH	RADIUS**
60002	1000	137+96.76	-74.000	233541.6176	614128.9645	N 88°29'38" E	42.168				
60004	1000	138+38.93	-74.000	233542.7259	614171.1180	S 1°30'22" E	20.000				
60008	1000	138+38.93	-54.000	233522.7328	614171.6436	N 88°29'38" E	50.000				
60005	1000	138+88.93	-54.000	233524.0470	614221.6264	S 71°16'53" E	40.497				
60006	1000	139+26.93	-40.000	233511.0506	614259.9812	S 2°45'07" E	5.064				
60007	1000	139+27.04	-34.938	233505.9928	614260.2243	S 87°14'53" W	124.554				
60003	1000	138+02.51	-32.229	233500.0126	614135.8135	N 9°20'54" W	42.165				
60002	1000	137+96.76	-74.000	233541.6176	614128.9645						
FIGURE 50001 AREA = 3123.00 SQ. FT. (0.072 ACRES).											
DEED RECORD OF ACQUISITION:											
ASSESSMENT NUMBER		OWNERSHIP OF RECORD						TYPE OF ACQUISITION	TITLE SOURCE	PARCEL AREA (ACRES)	PAGE NUMBER
132-2.00-111.00		(200) DEEP CREEK HOMEOWNERS ASSOCIATION INC.						TCE	5139-329	A - 12.890	15
PT. NO.	ALIGN. NO.	STATION	OFFSET*	NORTH	EAST	BEARING	DISTANCE	CHORD BEARING	CHORD LENGTH	ARC LENGTH	RADIUS**
60009	1000	137+41.78	40.000	233426.2120	614077.0047	N 88°29'38" E	61.855				
60010	1000	138+03.64	40.000	233427.8378	614138.8382	S 1°30'22" E	1.554				
60011	1000	138+03.64	41.554	233426.2847	614138.8790	S 43°01'35" W	28.411				
60012	1000	137+63.71	61.806	233405.5152	614119.4932	S 70°41'17" W	31.192				
60013	1000	137+54.02	71.345	233395.1996	614090.0564	N 22°49'27" W	33.647				
60009	1000	137+41.78	40.000	233426.2120	614077.0047						
FIGURE 50002 AREA = 1213.66 SQ. FT. (0.028 ACRES).											
DEED RECORD OF ACQUISITION:											
ASSESSMENT NUMBER		OWNERSHIP OF RECORD						TYPE OF ACQUISITION	TITLE SOURCE	PARCEL AREA (ACRES)	PAGE NUMBER
132-2.00-110.00		(201) ELEXES TOUSSAINT MOORE HEIRS & JAMES R WEBB JR.						TCE	WR 19780427	A - 2.600	15
PT. NO.	ALIGN. NO.	STATION	OFFSET*	NORTH	EAST	BEARING	DISTANCE	CHORD BEARING	CHORD LENGTH	ARC LENGTH	RADIUS**
60010	1000	138+03.64	40.000	233427.8378	614138.8382	N 88°29'38" E	93.673				
60019	1000	138+97.31	40.000	233430.2999	614232.4789	S 15°59'08" W	22.018				
60020	1000	138+90.69	61.000	233409.1332	614226.4153	S 88°29'38" W	26.910				
60016	1000	138+63.78	61.000	233408.4259	614199.5145	S 61°55'44" W	44.721				
60017	1000	138+23.78	81.000	233387.3814	614160.0540	S 88°29'38" W	66.000				
60018	1000	137+57.78	81.000	233385.6467	614094.0768	N 22°49'27" W	10.364				
60013	1000	137+54.02	71.345	233395.1996	614090.0564	N 70°41'17" E	31.192				
60012	1000	137+63.71	61.806	233405.5152	614119.4932	N 43°01'35" E	28.411				
60011	1000	138+03.64	41.554	233426.2847	614138.8790	N 1°30'22" W	1.554				
60010	1000	138+03.64	40.000	233427.8378	614138.8382						
FIGURE 50003 AREA = 3694.94 SQ. FT. (0.085 ACRES).											
DEED RECORD OF ACQUISITION:											
ASSESSMENT NUMBER		OWNERSHIP OF RECORD						TYPE OF ACQUISITION	TITLE SOURCE	PARCEL AREA (ACRES)	PAGE NUMBER
132-2.00-109.00		(202) FRANK L. AND MARY FRANCES MORRIS REVOCABLE TRUST						TCE	3417-156	D - 2.750	15
PT. NO.	ALIGN. NO.	STATION	OFFSET*	NORTH	EAST	BEARING	DISTANCE	CHORD BEARING	CHORD LENGTH	ARC LENGTH	RADIUS**
60019	1000	138+97.31	40.000	233430.2999	614232.4789	N 88°29'38" E	52.472				
60014	1000	139+49.78	40.000	233431.6790	614284.9328	S 1°30'22" E	21.000				
60015	1000	139+49.78	61.000	233410.6863	614285.4848	S 88°29'38" W	59.090				
60020	1000	138+90.69	61.000	233409.1332	614226.4153	N 15°59'08" E	22.018				
60019	1000	138+97.31	40.000	233430.2999	614232.4789						
FIGURE 50004 AREA = 1171.40 SQ. FT. (0.027 ACRES).											
DEED RECORD OF ACQUISITION:											

LEGEND	
RW	AREA OF ACQUISITION
PE	PERMANENT EASEMENT
TCE	TEMPORARY CONSTRUCTION EASEMENT
RW/PE	RIGHT-OF-WAY BY PE
*	OFFSET IS LEFT OF BASELINE
**	CURVE TURNS TO THE LEFT

REVISIONS	

NOT TO SCALE

**PAVEMENT & REHABILITATION,
SUSSEX I, (HARDSCRABBLE &
CONCORD), 2025**

CONTRACT	BRIDGE NO.	3-243
T202506301	DESIGNED BY:	M. HADDAD
COUNTY	CHECKED BY:	S. RODRIGUEZ
SUSSEX		

RIGHT-OF-WAY DATA SHEET	
SECTION	BR
SHEET NO.	16